

129 W GENESEE STREET
SPLASH CAR WASH

SITE DEVELOPMENT

T.A.#018.-06-09.1, 018.-06-08.0,
018.-06-07.1, 018.06-07.2

VILLAGE OF FAYETTEVILLE
ONONDAGA COUNTY
STATE OF NEW YORK

TABLE OF CONTENTS	
SHEET NO.	DESCRIPTION
C0	COVER SHEET
C1	NOTES & LEGEND
C2	EXISTING FEATURES MAP
C2A	EXISTING CONDITIONS PLAN & DEMO PLAN
C3	SITE PLAN
C4	UTILITY PLAN
C5	GRADING PLAN
C6	LIGHTING PLAN
C7	LANDSCAPE PLAN
C8	CONSTRUCTION DETAILS - 1
C9	CONSTRUCTION DETAILS - 2
C10	CONSTRUCTION DETAILS - 3
C11	NYSDOT WZTC DETAILS

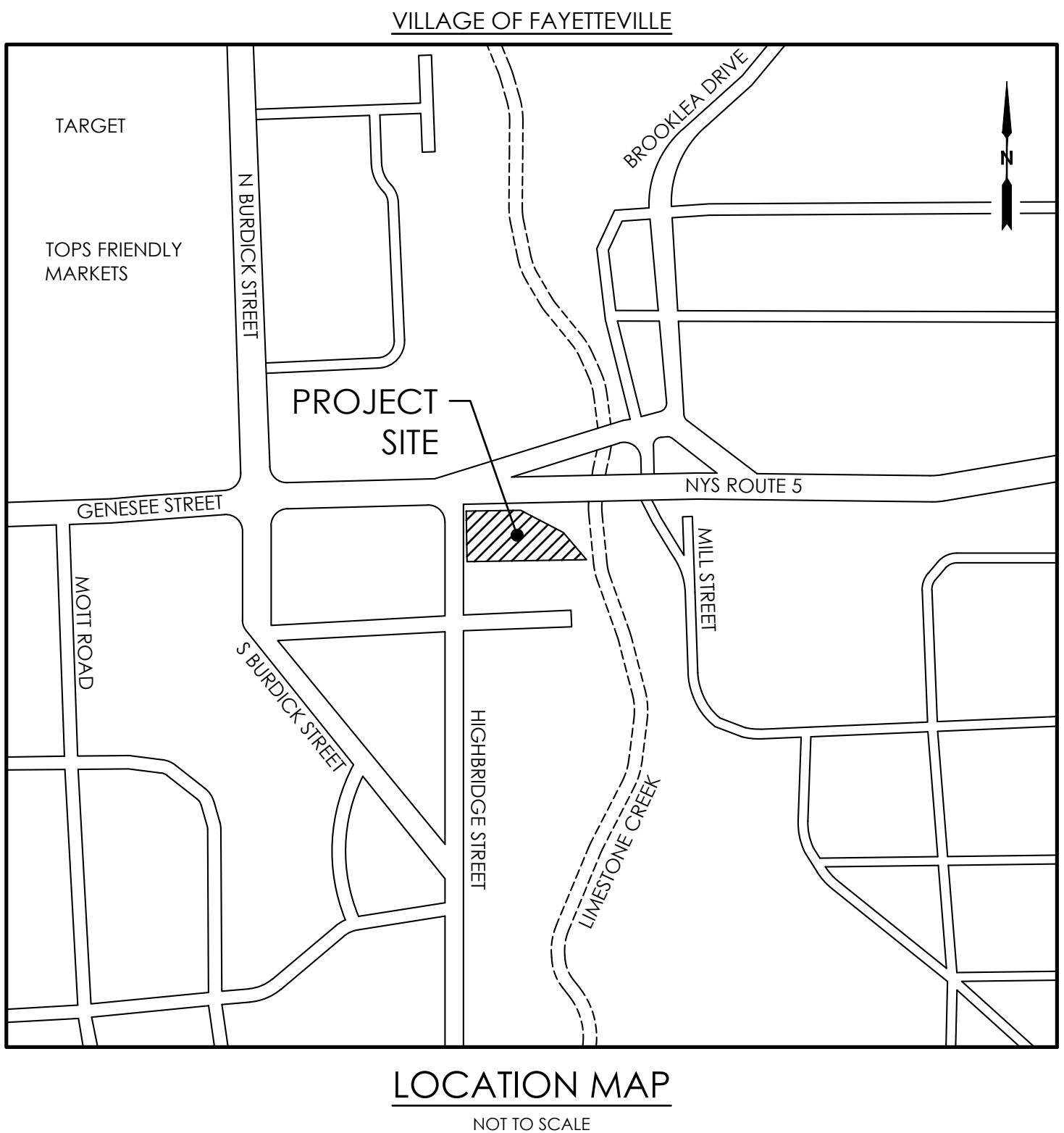

PREPARED FOR:



472 WHEELERS FARM RD
MILFORD, CT 06461

PREPARED BY:



45 HENDRIX ROAD
WEST HENRIETTA, NY 14586
PHONE (585) 359-7540
FAX (585) 359-7547

LEGEND

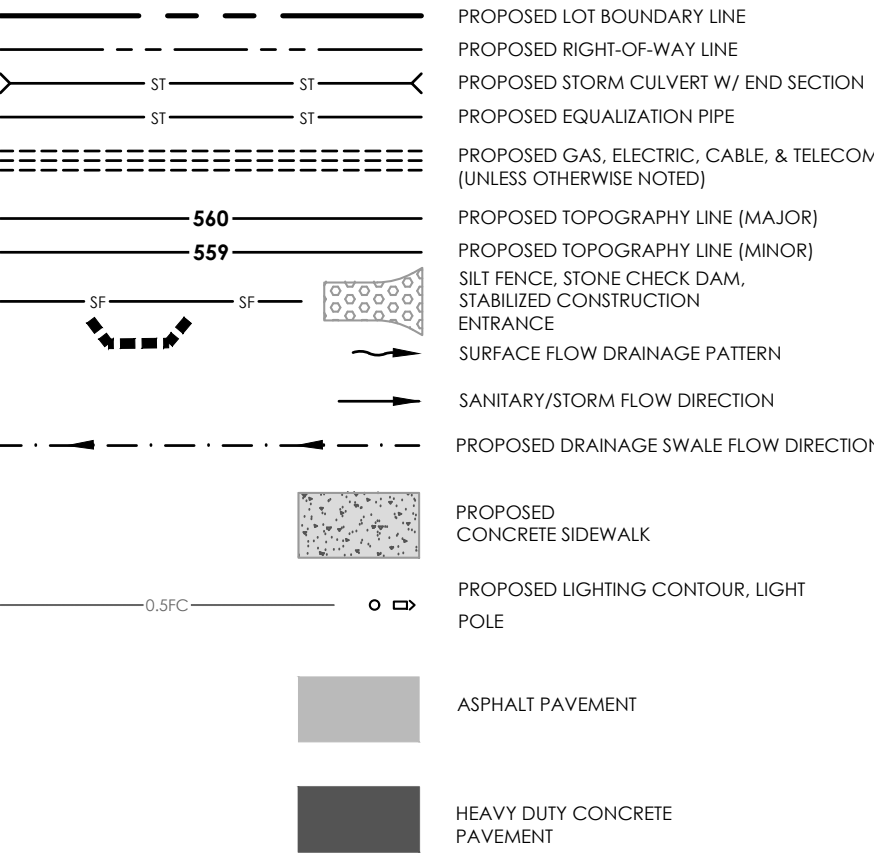
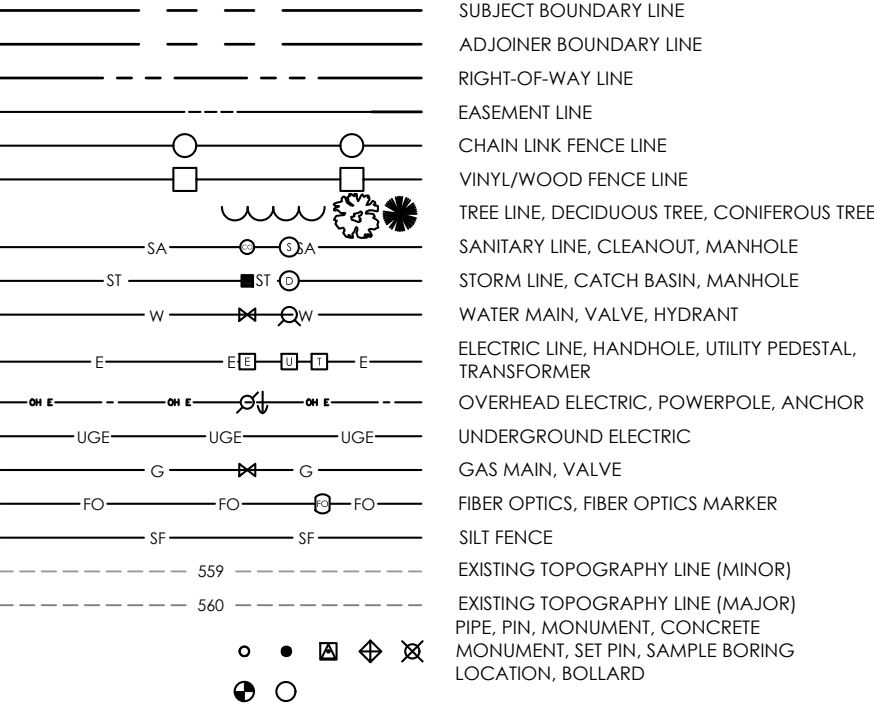

ABBREVIATIONS

EX.	EXISTING
N/F	NOW OR FORMALLY
TYP.	TYPICAL
W/	WITH
Ø	DIAMETER
T.A.	TAX ACCOUNT NUMBER
P.M.L	UTILITY PAINT MARK LOCATION
EX.	PER RECORD MAPPING
LAT.	LATERAL
SWR.	SEWER
C.O.	CLEANOUT
CB	CATCH BASIN
M.H.	MANHOLE
F.F.E	FINISHED FLOOR ELEVATION
TBR	TO BE REMOVED

SITE NOTES:

- PROJECT AREA IS LOCATED IN FLOOD ZONE AE AT ELEVATION 439' AS PER FLOOD INSURANCE RATE MAP COMMUNITY PANEL NO. 0244F DATED NOVEMBER 4, 2016.
- CONTRACTOR TO VERIFY LOCATION OF ANY GOVERNMENT MONUMENTS WITHIN THE SCOPE OF THE DEVELOPMENT. CONTRACTOR WILL BE RESPONSIBLE FOR PROTECTING ANY MONUMENTS SHOULD THEY EXIST WITHIN THE PROJECT SITE.
- GENESEE ST SHALL BE KEPT CLEAN AND FREE OF DEBRIS DURING CONSTRUCTION.
- NATIVE AND EXISTING VEGETATION SHOULD BE RETAINED AND PROTECTED TO THE GREATEST EXTENT POSSIBLE AND INCORPORATED INTO THE LANDSCAPE PLAN.
- DEVELOPER IS TO OBTAIN ANY APPROPRIATE STATE, COUNTY AND TOWN PERMITS PRIOR TO CONNECTING TO ANY PUBLIC UTILITIES.
- UNDERGROUND UTILITY LOCATIONS ARE APPROXIMATE. ALL UTILITIES SHALL BE FIELD STAKED BEFORE COMMENCING WORK. CONTRACTOR IS CAUTIONED TO NOTIFY CENTRAL STAKEOUT NUMBER 1-800-962-7962 OF RELOCATION OF UNDERGROUND UTILITY LOCATION PRIOR TO CONSTRUCTION.
- UPON COMPLETION OF THE PROJECT, THE DEVELOPER SHALL SUBMIT A LANDSCAPE CERTIFICATE OF COMPLIANCE TO THE BUILDING DEPARTMENT FROM THE LANDSCAPE ARCHITECT WHO IS CERTIFYING THAT ALL OF THE APPROVED PLANTINGS HAVE BEEN FURNISHED AND INSTALLED IN SUBSTANTIAL COMPLIANCE WITH THE APPROVED LANDSCAPING PLAN.

EROSION & SEDIMENT CONTROLS

- THE PROJECT WILL DISTURB APPROXIMATELY 1.17 ACRES AND THEREFORE WILL REQUIRE COVERAGE UNDER THE NYSDEC SPDES GENERAL PERMIT FOR STORMWATER DISCHARGES (GP-0-20-001).
 - PROCEDURES OUTLINED IN THE NEW YORK STATE STANDARDS AND SPECIFICATIONS FOR EROSION AND SEDIMENT CONTROL MUST BE FOLLOWED THROUGHOUT THE DURATION OF CONSTRUCTION OF THIS PROJECT. THROUGHOUT CONSTRUCTION, EMPHASIS WILL BE PLACED ON PREVENTING EROSION OF THE DISTURBED AND EXPOSED SOIL WITHIN THE SITE.
 - VEGETATIVE MEASURES SUCH AS JUTE MESH, SEEDING AND MULCHING WILL BE UTILIZED TO HELP PREVENT ERODING OF THE SOIL.
 - BARE SOIL WILL BE SEEDED WITHIN 14 DAYS OF EXPOSURE UNLESS CONSTRUCTION WILL BEGIN WITHIN 21 DAYS. IF CONSTRUCTION IS SUSPENDED, OR SECTIONS COMPLETED, AREAS WILL BE SEEDED OR MULCHED IMMEDIATELY.
 - TEMPORARY SEEDING WILL CONSIST OF RYEGRASS PLACED AT A RATE OF 30 LBS. PER ACRE OR 0.7 LBS. PER 1,000SF. THE AREA IS TO THEN BE MULCHED WITH HAY OR STRAW AT A RATE OF 2 TONS PER ACRE OR 90 LBS. PER 1,000SF.
 - TOPSOIL SHALL BE PLACED AT A DEPTH OF 6" MINIMUM.
 - PERMANENT SEEDING SHALL FOLLOW THE CHART LISTED BELOW. MULCH SHALL BE SMALL GRAIN STRAW APPLIED AT A RATE OF 2 TONS PER ACRE OR 90 LBS. PER 1,000SF.
- | GENERAL SEED MIX: | VARIETY | LBS/ACRE | LBS/1,000SF |
|--|------------------------|----------------|----------------------|
| BIRDSFOOD TREFOIL*
OR
COMMON WHITE CLOVER* | EMPIRE/PARDEE | 8 LBS | 0.20 LBS |
| | COMMON | 8 LBS | 0.20 LBS |
| PLUS | | | |
| TALL FESCUE | KY-31/REBEL | 20 LBS | 0.45 LBS |
| PLUS | | | |
| REDTOP
OR
RYEGRASS (PERENNIAL) | COMMON
PENNINE/LINN | 2 LBS
5 LBS | 0.05 LBS
0.10 LBS |
- *ADD INOCULANT IMMEDIATELY PRIOR TO SEEDING
- SEDIMENT CONTROL CONCERNS ARE ADDRESSED BY USE OF PERIMETER CONTROLS SUCH AS SILT FENCE AND STONE CHECK DAMS.
 - THE PAVED STREET ADJACENT TO THE SITE ENTRANCE WILL BE SWEEP DAILY TO REMOVE ANY EXCESS MUD, DIRT OR ROCK TRACKED FROM THE SITE. DUMP TRUCKS HAULING MATERIAL FROM THE CONSTRUCTION SITE WHICH IS PRONE TO BLOWING FROM THE WIND WILL BE COVERED WITH A TARPULIN.

CONSTRUCTION SEQUENCE:

- THE PROPOSED EROSION AND SEDIMENT PLAN WILL BE DISCUSSED WITH CONTRACTORS BEFORE BEGINNING ANY EARTH DISTURBING ACTIVITIES TO ENSURE THAT ALL CONTRACTORS ARE AWARE OF THE PROPER INSTALLATION OF THE EASC MEASURES AND THE NEED FOR ANY MAINTENANCE, WHICH MAY BE REQUIRED AS THE PROJECT PROGRESSES. THIS WILL BE IMPORTANT IN PROTECTING THE ADJACENT PROPERTIES' TREES DURING THE CONSTRUCTION PERIOD.
- EXPOSURE OF DISTURBED EARTH DURING THE MASS EARTHWORK PHASE WILL BE LESS THAN 5 ACRES. IT IS RECOMMENDED THAT THE CONTRACTOR FOLLOW THE SEQUENCE OF CONSTRUCTION OPERATIONS.
- CONTRACTOR TO INSTALL STABILIZED CONSTRUCTION ENTRANCE AT LOCATION SHOWN ON THE GRADING PLAN PER DETAIL FOUND ON SHEET C8.
- BEFORE REMOVAL OF ANY ADDITIONAL ASPHALT SURFACING INSTALL PERIMETER SEDIMENT CONTROLS (SILT FENCING) AT LOCATIONS SHOWN ON PLAN. IMMEDIATELY STABILIZE ANY AREAS DISTURBED BY THIS ACTIVITY. USE CARE TO AVOID DAMAGING TREES WHICH ARE TO REMAIN.
- REMOVE TREES CALLED OUT TO BE REMOVED ON THE DEMOLITION PLAN. PROTECT EXISTING TREES, VEGETATION, AND OTHER ENVIRONMENTAL FEATURES WHICH ARE TO REMAIN.
- INSTALL ALL REMAINING EROSION AND SEDIMENT CONTROLS ACCORDING TO THE PLAN.
- CONSTRUCT STAGING AREA(S) AS REQUIRED.
- THE OPERATOR AND OWNER/DEVELOPER SHALL COMPLETE AN ASSESSMENT OF THE SITE PRIOR TO THE COMMENCEMENT OF CONSTRUCTION ACTIVITIES.
- REMOVE AND DISPOSE EXISTING ASPHALT/CONCRETE SURFACES AS CALLED OUT ON THE DEMOLITION PLAN.
- WITHIN 14 DAYS OF EXPOSURE, STABILIZE ALL DISTURBED AREAS, WHICH WILL REMAIN INACTIVE FOR 21 DAYS OR MORE (I.E. OUTSIDE AREA WHICH WILL BE DEVELOPED TO INTO LAWN).
- INSTALL STORMWATER MANAGEMENT FACILITIES AS REQUIRED AND ACCORDING TO THE PLAN.
- INSTALL DRIVEWAY STONE BASE.
- PERFORM CONSTRUCTION ACTIVITIES IN ACCORDANCE WITH THE SITE UTILITY AND GRADING PLAN.
- COMPLETE FINAL SITE GRADING, REAPPLY TOPSOIL (MINIMUM 6" THICKNESS), INSTALL PERMANENT SEEDING, FERTILIZER, AND MULCH.
- UPON PERMANENT STABILIZATION OF INDIVIDUAL PORTIONS OF THE SITE, REMOVE INDIVIDUAL TEMPORARY SEDIMENTATION CONTROL MEASURES AS APPROPRIATE. SEDIMENT CONTROL MEASURES NOT TO BE REMOVED UNTIL APPROVAL HAS BEEN OBTAINED FROM THE VILLAGE OF FAYETTEVILLE CODE ENFORCEMENT OFFICER OR THE TOWN ENGINEER.

NYSDOT WORK ZONE TRAFFIC CONTROL NOTES

- WORK ZONE TRAFFIC CONTROL REVISIONS

Proposed revisions to the Work Zone Traffic Control (WZTC) plan or modifications to the 619 Standard Sheets shall be submitted to the engineer for the review and approval by the Regional Traffic Engineer prior to the planned implementation of such revisions or modifications. The Contractor shall not implement the proposed revisions without approval from the Regional Traffic Engineer. When applicable, NYSDOT Work Zone Traffic Control (WZTC) typical applications shall be used. Typical can be found at <https://webapps.dot.ny.gov/work-zone-traffic-control>

- TRAVEL LANE WIDTHS IN WORK ZONES

Where not shown in the WZTC plans or otherwise authorized by NYS DOT (or The Engineer), travel lane widths in work zones shall be a minimum of 11 ft on freeways, ramps, expressways and multi-lane* conventional roadways and 10 ft on all other conventional roadways.

*Multi-lane roadways are those with two or more travel lanes in one or both directions.)

There shall be no closures between the hours of 4PM-6PM.

- DAILY LANE, RAMP AND SHOULDER CLOSURE RESTRICTIONS

Work zones shall be restricted to one side of the roadway at a time in each direction on divided roadways, unless approved by the Engineer. The Contractor shall schedule work so that all travel lanes and ramps in each direction are open when the Contractor's operations are closed down or substantially closed down. Daily closures may occur off of long-term closures and shall be subject to daily closure restrictions. Work zones shall be restricted to one side of the roadway at a time on undivided highways.

- FLAGGING OPERATIONS

When a pedestrian approaches a Flagger Station, the flagger shall stop traffic and direct the pedestrian to a safe route through the work area. Flaggers shall coordinate the flagging of the work zone to ensure pedestrians can safely proceed through the area. If there is more than the occasional pedestrian within the project limits, refer to the site specific pedestrian WZTC plan.

- SIGNALIZED INTERSECTIONS

When construction operations effect signalized intersections, the traffic signal shall be turned off before proceeding with the flagging operation, and any existing W3-3 signs covered. The contractor shall return the signal to a 3-color operation at the end of the work operation. If the signal does not return to 3-color operation, the contractor shall notify the Region 3 Signal crew and remain until the Signal crew arrives and the signal is repaired. The contractor shall obtain a police panel key from, and return it to, the Region 3 NYS DOT Signal crew EIC. The NYS DOT Signal Crew EIC can be reached at 315-428-4064 or 315-426-2131.

- HOLIDAY CLOSURE RESTRICTIONS

Daily lane, ramp and shoulder closures shall not be permitted on state owned roadways during major holidays. For a list of the major holidays, see special note in the contract proposal for temporary lane closure restrictions for major holidays. Daily lane, ramp and shoulder closures shall not be permitted as described in EI 17-010. Below are holiday periods based on guidelines from EI 17-010. All restrictions are from 6:00 AM on the first day until 6:00 AM on the last day of the restriction:

2023
6:00 am Friday, December 30, 2022 thru 6:00 am Tuesday, January 3, 2023 - (New Year's Holiday)
6:00 am Friday, May 24, 2023 thru 6:00 am Tuesday, May 30, 2023 - (Memorial Day Holiday)
6:00 am Saturday, July 1, 2023 thru 6:00 am Wednesday, July 5, 2023 - (July 4th Holiday)
6:00 am Friday, September 1, 2023 thru 6:00 am Tuesday, September 5, 2023 - (Labor Day Holiday)
6:00 am Wednesday, November 22, 2023 thru 6:00 am Monday, November 27, 2023 - (Thanksgiving Holiday)
6:00 am Friday, December 22, 2023 thru 6:00 am Tuesday, December 26, 2024 - (Christmas Holiday)
6:00 am Friday, December 29, 2023 thru 6:00 am Thursday, January 2, 2024 - (New Year's Holiday)
2024
6:00 am Friday, December 29, 2023 thru 6:00 am Tuesday, January 2, 2024 - (New Year's Holiday)
6:00 am Friday, May 24, 2024 thru 6:00 am Tuesday, May 28, 2024 - (Memorial Day Holiday)
6:00 am Thursday, July 4, 2024 thru 6:00 am Monday, July 8, 2024 - (July 4th Holiday)
6:00 am Friday, August 30, 2024 thru 6:00 am Tuesday, September 3, 2024 - (Labor Day Holiday)
6:00 am Wednesday, November 27, 2024 thru 6:00 am Monday, December 2, 2024 - (Thanksgiving Holiday)
6:00 am Saturday, December 21, 2024 thru 6:00 am Thursday, December 26, 2024 - (Christmas Holiday)
6:00 am Tuesday, December 31, 2024 thru 6:00 am Thursday, January 2, 2025 - (New Year's Holiday)

- NOTIFICATION REQUIREMENTS

Region 3 has a Work Zone Traffic Control (WZTC) Notification Policy which requires Engineers/Contractor to notify the Regional Transportation Management Center (RTMC) prior to allowing a contractor to implement Work Zone Traffic Control activities within the highway right of way. Work Zone Notification is required for the following:

Freeways and Expressways: All lane, shoulder, road, ramp or bridge closures.
(This includes mobile operations which occupy the lane or shoulders.)

All Other State Highways: All lane closures whose duration will be greater than 2 hours and all road/bridge closures.

The Contractor shall report proposed WZTC activities noted above to the TMC by NOON of the business day (i.e. Monday through Friday excluding holidays) preceding the proposed WZTC activity. Failure to do so will result in disapproval to perform the unreported WZTC activity until the above notifications requirements are satisfied. No planned WZTC activity shall be implemented without first receiving clearance from the RTMC.

- VEHICLE RESTRICTIONS

The Contractor shall report any restriction (as defined below) on highways, ramps, or bridges at least six (6) business weekdays in advance of the restriction. Six (6) days lead time is necessary to provide the RTMC adequate time to prevent issuance of Special Hauling Permits that would route oversize vehicles over the restricted section of this contract.

Restrictions shall be defined as one or more of the following:

- Complete closure of a highway, ramp or bridge.
- Installation of barrier or channelizing devices that result in an unobstructed width less than 18 feet along a highway, ramp or bridge.
- Suitable driving surfaces of less than 18 feet in width.
- Available vertical clearance above the highway is less than 14 feet in height.
- Work would limit vehicle length (i.e. turning ability)
- Changing the load capacity of a highway, ramp or bridge.

- WORK AREA COORDINATION

The Contractor shall coordinate work activities with other contracts within and/or adjacent to the contract work limits.

- ACCESS

The Contractor shall ensure that active lanes of traffic on Freeways are not crossed by pedestrian workers. For all other highways, the contractor shall ensure that pedestrian workers cross active lanes of traffic only at properly marked or unmarked crosswalks and/or dedicated pedestrian walkways. It is required that the Project Safety and Health Plan address access to each work and staging area. Where it is feasible, vehicles and equipment used for the work and transporting of workers to/from the work site shall enter and leave the area closed by channelizing devices within the Termination Area of the Temporary Traffic Control Zone. Where such access within the Termination Area is not feasible, other areas for entry and exit shall be determined and included in the Project Safety & Health Plan, including illustrated examples (Typicals) to clearly show the temporary traffic control elements that will be provided.

- CHANNELIZING DEVICES

All channelizing devices shall be placed so as to provide a 2 foot lateral clearance to the traveled way unless otherwise shown on the plans. Where possible a lateral buffer space of 2 foot minimum shall be provided between the work space and the channelizing devices. Channelizing device spacing (center to center) shall be 40' maximum for posted speed limits 40 mph or greater and 20' maximum for posted speed limits 35 mph or less. Standard cones and tubular markers shall not be used for channelization and delineation during the hours of darkness, which is defined as the period between sunset and sunrise.

- SIGNS

All construction signs shall be mounted at a height of 7 feet above the edge of travel lane. Signs shall not encroach more than 4" into shoulders used by pedestrians or bicycles. Where shoulder widths are limited and signs cannot be erected beyond the shoulder, construction signs may need to be mounted on concrete median barriers, bridge parapets, etc.

NYSDOT WORK ZONE TRAFFIC CONTROL NOTES (CONTINUED)

- REQUIREMENTS FOR VARIABLE MESSAGE SIGNS

- The use of Portable Variable Message Signs (PVMS) is intended to advise traffic of upcoming and actual changes to regular traffic patterns.
- The PVMS shall be placed at the locations shown on the Work Zone Traffic Control (WZTC) plans and other locations specified by the engineer. The PVMS shall be placed seven (7) days before any bridge/road closure and/or any temporary signal placement is to begin and will remain in place until all work within a designated WZTC phase has been completed. Seven (7) days prior to a closure taking place, and/or any temporary signal placement, the initial message shown in the contract plans shall be displayed. Once the closure has taken place and/or temporary signal is activated, the PVMS's shall remain on for the duration of the closure and/or activated temporary signal displayed with the message shown in the plans.
- PVMS units to be located within shoulder closure per Standard Sheet 619-22 when located within clear zone.
- PVMS units located behind guide rail shall not be located within rail deflection distance. See section 619 of the Standard Specifications.
- PVMS units shall be installed and maintained in accordance with Section 619 of the Standard Specification and item 619.1.1xxx.
- See Drawing Nos. xx-xx for portable variable message sign (PVMS) locations.
- The Contractor shall provide the EIC with the model, manufacturer date and manufacturer of which the National Transportation Communication for ITS Protocol (NTCIP) compliant PVMS the contractor plans to use from the Department's "Approved" list. The PVMS will need to accept any communications from the NYS DOT Regional Transportation Management Center (TMC) in Syracuse, NY.

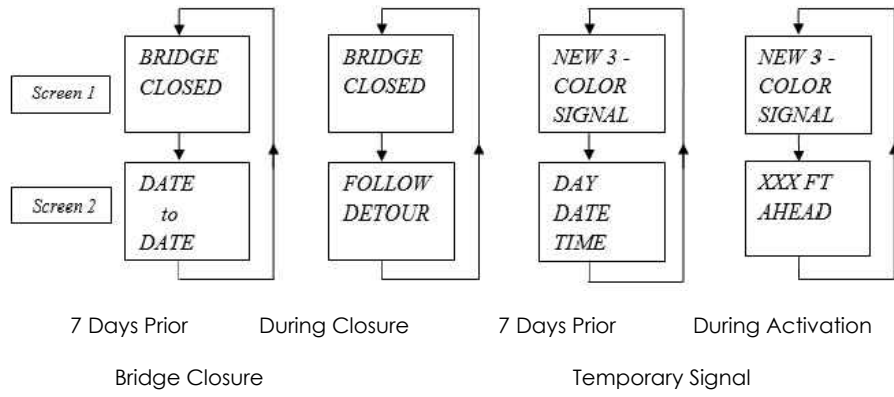

- MISCELLANEOUS (local or Permit projects)

- The Contractor shall be aware that the Work Zone Traffic Control is a very critical item of the permit and shall be provided in accordance with Section 619 "Work Zone Traffic Control" of the Standard Specifications, the 2009 edition of the National Manual on Uniform Traffic Control Devices for Streets and Highways and the New York State Supplement. The Contractor shall be responsible for Work Zone Traffic Control at all times for the duration of the permitted work.
- Actual field conditions may require other signs and other arrangements of signs. Distances shall be adapted to prevailing conditions. Signs shall be located to provide optimum visibility. Signs that are not applicable shall be covered or obscured from sight. All sign numbers refer to the 2009 edition of the National Manual on Uniform Traffic Control Devices for Streets and Highways and the New York State Supplement.
- Pedestrian accommodations shall be maintained for the duration of the proposed work. Any disturbed areas within the State Right-of-Way shall be adequately fenced to prevent pedestrian access when the contractors operations are shut down.
- Materials, equipment and vehicles shall not be stored or parked within the State Right-of-Way before work begins or after contractor's operations are shut down. Staging areas outside the right-of-way shall be used to stockpile all construction materials. During working hours, no construction material may be stored or placed on the roadway or roadbed except within a protected work area.
- Vehicles belonging to the Contractor or workers shall not be parked within 30 feet of the edge of pavement along a roadway being used by the general public, unless they are parked within a protected work area. During non-working hours, construction equipment and materials shall not be stored within 30 feet of the edge of pavement.
- W20-7A "Flagger" signs shall be used whenever flagging occurs for more than a brief period of time. The signs shall be promptly removed, covered, or ensure maximum visibility. When the flagging operation ceases, all flagging stations and lane closures shall be located to ensure maximum visibility.
- No drop-off greater than six inches shall be left overnight within 30 feet of the edge of pavement. Drop-offs less than six inches will be permitted if proper delineation and signing is provided, and prior permission is granted in writing by a representative of the Department. A drop-off is considered eliminated if tapered away by a 1 on 6 slope or flatter.
- Care shall be taken to insure that no damage occurs to the existing pavement/shoulder/curb areas as a result of construction equipment movement.
- The Contractor may submit revisions to this plan for approval, but any change that alters the basic concepts of the plan must be approved by the NYSDOT Regional Director or his designee.

N.Y.S.D.O.T. GENERAL PLAN NOTES

- ROAD TO BE KEPT CLEAN OF MUD AND DEBRIS AT ALL TIMES.
- ROADSIDE DRAINAGE TO BE MAINTAINED AT ALL TIMES.
- MATERIALS, EQUIPMENT AND VEHICLES ARE NOT TO BE STORED OR PARKED WITHIN THE NEW YORK STATE RIGHT-OF-WAY.
- MAINTENANCE AND PROTECTION OF TRAFFIC MUST COMPLY WITH THE CURRENT NATIONAL MUTCD WITH NYS SUPPLEMENT, SECTION 619 OF THE CURRENT NYSDOT STANDARD SPECIFICATIONS, THESE PLANS AND AS ORDERED BY THE ASSISTANT RESIDENT ENGINEER. ON A NYSDOT CONSTRUCTION PROJECT, MAINTENANCE AND PROTECTION OF TRAFFIC MUST COMPLY WITH THESE PLANS AND BE IN ACCORDANCE WITH THE NYSDOT CONTRACT DOCUMENTS AS DEEMED NECESSARY BY THE NYS ENGINEER-IN-CHARGE.
- NOTIFY THE NEW YORK STATE DEPARTMENT OF TRANSPORTATION'S ASSISTANT RESIDENT ENGINEER AT THE APPROPRIATE NUMBER, FIVE (5) WORK DAYS PRIOR TO WORKING WITHIN THE STATE RIGHT-OF-WAY.
- IN ADDITION, THE PERMITTEE SHALL NOTIFY NYSDOT REGIONAL TRAFFIC OPERATIONS CENTER (RTOC) OF ALL LANE AND SHOULDER CLOSURES AT LEAST THREE (3) DAYS IN ADVANCE OF THE PROPOSED WORK UTILIZING RTOC'S CONSTRUCTION NOTIFICATION FORM. RTOC'S CONSTRUCTION NOTIFICATION FORM CAN BE OBTAINED FROM THE 511 NY NOTIFICATION LINK AT THE WORK ZONE TRAFFIC CONTROL ICON ON THE REGION 4 PERMITS WEBSITE: WWW.DOT.NY.GOV/R4WORKPERMITS.
- NOTIFY THE NYSDOT SIGNAL MAINTENANCE FACILITY AT (585) 753-7780 5 DAYS PRIOR TO WORKING WITHIN 350' OF A SIGNALIZED INTERSECTION. NOTIFY DG SAFELY NEW YORK 2 WORK DAYS PRIOR TO DIGGING, DRILLING OR BLASTING AT 611 FOR A UTILITY STAKE-OUT.
- ALL MATERIALS USED WITHIN THE STATE RIGHT-OF-WAY MUST COMPLY WITH THE CURRENT NEW YORK STATE DEPARTMENT OF TRANSPORTATION SPECIFICATIONS ALONG WITH ANY APPROPRIATE CURRENT NYS DEPARTMENT OF TRANSPORTATION'S STANDARD SHEETS.
- QUALITY CONTROL OF ASPHALT CONCRETE SHALL MEET THE REQUIREMENTS OF SECTION 401 OF THE STANDARD SPECIFICATIONS. ALL ASPHALT PRODUCED AS PART OF SECTION 401 WILL BE PAID AT A FINAL QUANTITY ADJUSTMENT FACTOR OF 1.0. ASPHALT COURSE DEPTHS SHOWN ON THE PLANS ARE COMPACTED DEPTHS.
- NO NIGHT WORK SHALL BE ALLOWED UNLESS APPROVED PRIOR TO START OF PROJECT. ADDITIONAL MAINTENANCE AND PROTECTION OF TRAFFIC MAY BE REQUIRED INCLUDING THE APPLICATION OF REFLECTIVE MATERIALS AND LIGHTING.
- HAZARDOUS WASTE NOTIFICATION - THE PERMITTEE ACCEPTS THE RIGHT-OF-WAY OF THE STATE HIGHWAY IN ITS "AS IS" CONDITION. THE DEPARTMENT OF TRANSPORTATION MAKES NO REPRESENTATION AS TO THE ABSENCE OF UNDERGROUND TANKS, STRUCTURES, FEATURES OR SIMILAR IMPEDIMENTS TO THE COMPLETION OF THE WORK PERMITTED HEREUNDER. SHOULD PERMITTEE FIND SOME PREVIOUSLY UNKNOWN UNDERGROUND IMPEDIMENTS TO ITS WORK, THE DEPARTMENT OF TRANSPORTATION SHALL HAVE NO OBLIGATION TO CURE, REMOVE, REMEDY OR OTHERWISE DEAL WITH SUCH PREVIOUSLY UNKNOWN UNDERGROUND IMPEDIMENTS. THE PERMITTEE IS REQUIRED TO REMOVE, MODIFY OR OTHERWISE DEAL WITH SUCH UNDERGROUND TANKS, STRUCTURES, FEATURES OR IMPEDIMENTS IN A MANNER WHICH MEETS ACCEPTABLE ENGINEERING PRACTICE AND IS APPROVED BY THE DEPARTMENT OF TRANSPORTATION.
- ADA COMPLIANCE - ALL WORK ON PEDESTRIAN FACILITIES SHALL BE COMPLIANT WITH THE AMERICANS WITH DISABILITIES ACT (ADA).



45 HENDRIX RD
WEST HENRIETTA, NY 14586
PHONE-(585)359-7540
FAX-(585)359-7541



SPLASH CAR WASH, INC
472 WHEELERS FARM RD
MILFORD, CT 06461
(585) 303 - 9448



DATE	DESCRIPTION	REV
8-29-22	REVISED PER VILLAGE OF FAYETTEVILLE TOWN ENGINEER COMMENTS	01
9-29-22	REVISED PER VILLAGE OF FAYETTEVILLE TOWN ENGINEER COMMENTS	02
11-21-22	REVISED PER VILLAGE OF FAYETTEVILLE TOWN ENGINEER COMMENTS	03
12-21-22	REVISED PER VILLAGE OF FAYETTEVILLE TOWN ENGINEER COMMENTS	04
1-24-23	REVISED PER VILLAGE OF FAYETTEVILLE TOWN ENGINEER COMMENTS	05
2-14-2023	REVISED PER VILLAGE OF FAYETTEVILLE TOWN ENGINEER COMMENTS	06
2-14-23	REVISED PER VILLAGE OF FAYETTEVILLE TOWN ENGINEER COMMENTS	07
2-14-23	REVISED PER VILLAGE OF FAYETTEVILLE TOWN ENGINEER COMMENTS	08
2-14-23	REVISED PER VILLAGE OF FAYETTEVILLE TOWN ENGINEER COMMENTS	09
10-19-23	EXPANDED DRIVE LANE LAYOUT (REVISED PER TOWN COMMENTS)	10

THESE DOCUMENTS INCLUDING ALL IDEAS, ARRANGEMENTS, DESIGNS AND PLANS INDICATED THEREON OR PRESENTED THEREBY ARE OWNED BY AND REMAIN THE PROPERTY OF THE ENGINEER. NO PART OF THESE DOCUMENTS SHALL BE REPRODUCED, COPIED, OR TRANSMITTED IN ANY FORM OR BY ANY MEANS, WITHOUT THE WRITTEN PERMISSION OF THE ENGINEER. ALL RIGHTS RESERVED. ©	
129 W GENESEE STREET SPLASH CAR WASH VILLAGE OF FAYETTEVILLE, ONONDAGA COUNTY, NEW YORK	NOTES AND LEGEND
DRAWING TITLE:	
DRAWN BY: SHC	ESM PROJ. NO: 72220023
CHECKED BY: CAK	DATE: 6-24-22
DATE:	PAGE SIZE:

REV: 10
DRAWING NO: C1

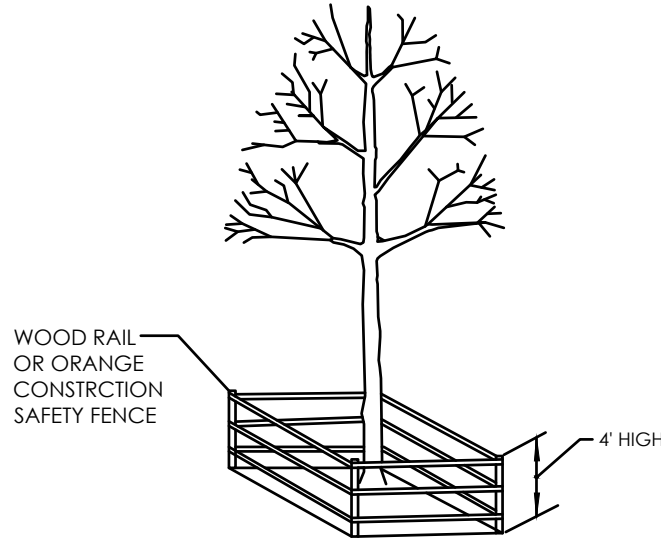
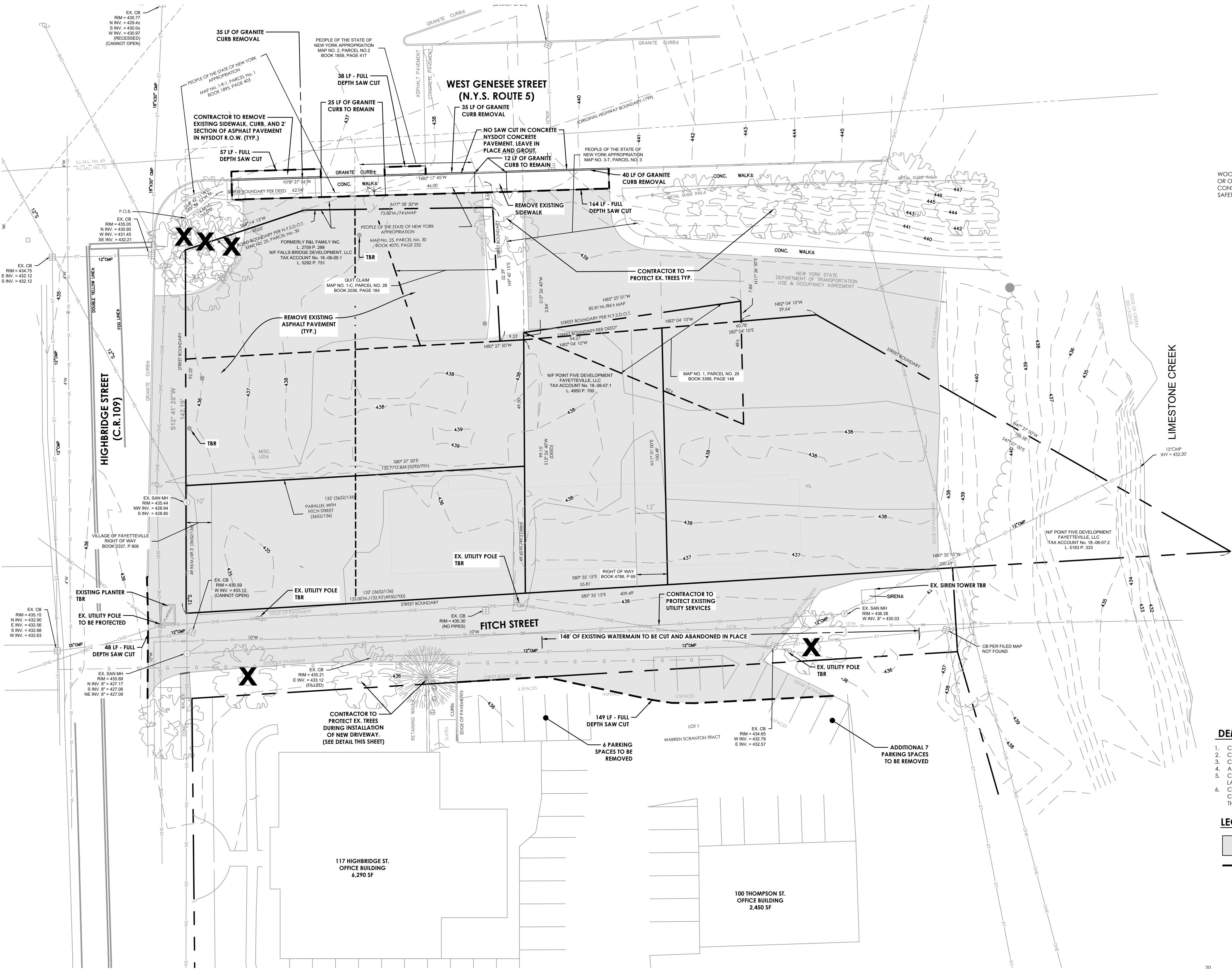

- NOTE:
1. ALL TREES WITHIN THE PROJECT LIMITS THAT ARE TO REMAIN, ARE TO RECEIVE THIS TREATMENT.
 2. DO NOT LEAVE CONSTRUCTION EQUIPMENT RUNNING (IDLING) UNDER TREE CANOPY.
 3. MATERIALS & EQUIPMENT STORAGE IS NOT ALLOWED IN FENCED AREAS.
 4. EXISTING PLANTS TO REMAIN, OR DIRECTLY ADJACENT TO, THE WORK AREA SHALL BE PROTECTED DURING CONSTRUCTION. ANY PLANTS INDICATED TO REMAIN THAT ARE DAMAGED TO CONSTRUCTION OPERATIONS ARE TO BE REPLACED IN KIND.

TREE DIAMETER (DBH)	DISTANCE OF FENCING FROM FACE OF TREE TRUNK
LESS THAN 10"	6'
10"-14"	10'
15"-19"	12'
20" OR MORE	15'

FENCING SHOULD BE PLACED AT TREE DRIP LINE OR DISTANCE GREATER

TREE PROTECTION ZONE FENCING

N.T.S.

- #### DEMOLITION NOTES:
1. COORDINATE ALL WATERLINE REMOVALS WITH OCWA
 2. COORDINATE ALL SEWER REMOVALS WITH OCWP
 3. COORDINATE ALL POWER REMOVALS WITH NATIONAL GRID
 4. ALL WORK WITHIN THE RIGHT OF WAY REQUIRES A PERMIT FROM NYSDOT AND OCDOT
 5. CONTRACTOR TO RESTORE SOIL AND ESTABLISH TURF IN ALL AREAS TO BE GRASS LAWN / LANDSCAPED. SEE SITE PLAN.
 6. CONTRACTOR SHALL VERIFY LOCATION AND DEPTH OF EXISTING TRAFFIC SIGNAL CONDUITS PRIOR TO SAW CUT OPERATIONS. ALL TRAFFIC SIGNALS SHALL BE PROTECTED THROUGHOUT THE DURATION OF CONSTRUCTION.

LEGEND

- REMOVE ASPHALT PAVEMENT
- PROPOSED FULL DEPTH SAWCUT
- CLEAR AND GRUB EXISTING TREE

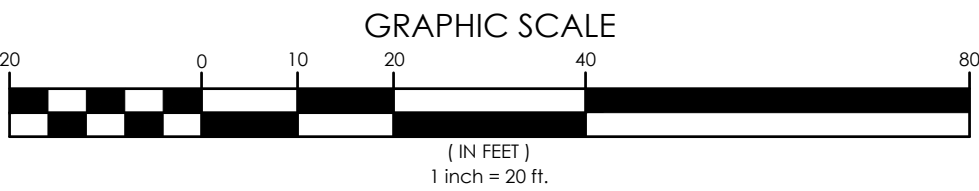

45 HENDRIX RD
WEST HENRIETTA, NY 14586
PHONE-(585)359-7540
FAX-(585)359-7541



SPLASH CAR WASH, INC
472 WHEELERS FARM RD
MILFORD, CT 06461
(585) 303-9448



REV	DESCRIPTION	DATE
01	REVISED PER VILLAGE PB & TOWN ENGINEER COMMENTS	8-29-22
02	REVISED PER VILLAGE PB & TOWN ENGINEER COMMENTS	9-29-22
03	REVISED PER VILLAGE PB & TOWN ENGINEER COMMENTS	10-27-22
04	REVISED PER VILLAGE PB & TOWN ENGINEER COMMENTS	11-21-22
05	REVISED PER VILLAGE PB AND NYSDOT COMMENTS	12-21-22
06	REVISED PER OCDOT COMMENTS	2-1-2023
07	REVISED PER OCDOT COMMENTS	2-1-2023
08	REVISED PER OCDOT COMMENTS	2-1-2023
09	REVISED PER TOWN COMMENTS	2-1-2023
10	EXPANDED DRIVE LANE LAYOUT (REVISED PER TOWN COMMENTS)	10-18-23

129 W GENESEE STREET
SPLASH CAR WASH
VILLAGE OF FAYETTEVILLE, ONONDAGA COUNTY, NEW YORK

DRAWING TITLE:
EXISTING CONDITIONS AND DEMOLITION PLAN

REV: 10
DRAWING NO: C2A
DATE: 6-24-22
PAGE: 5

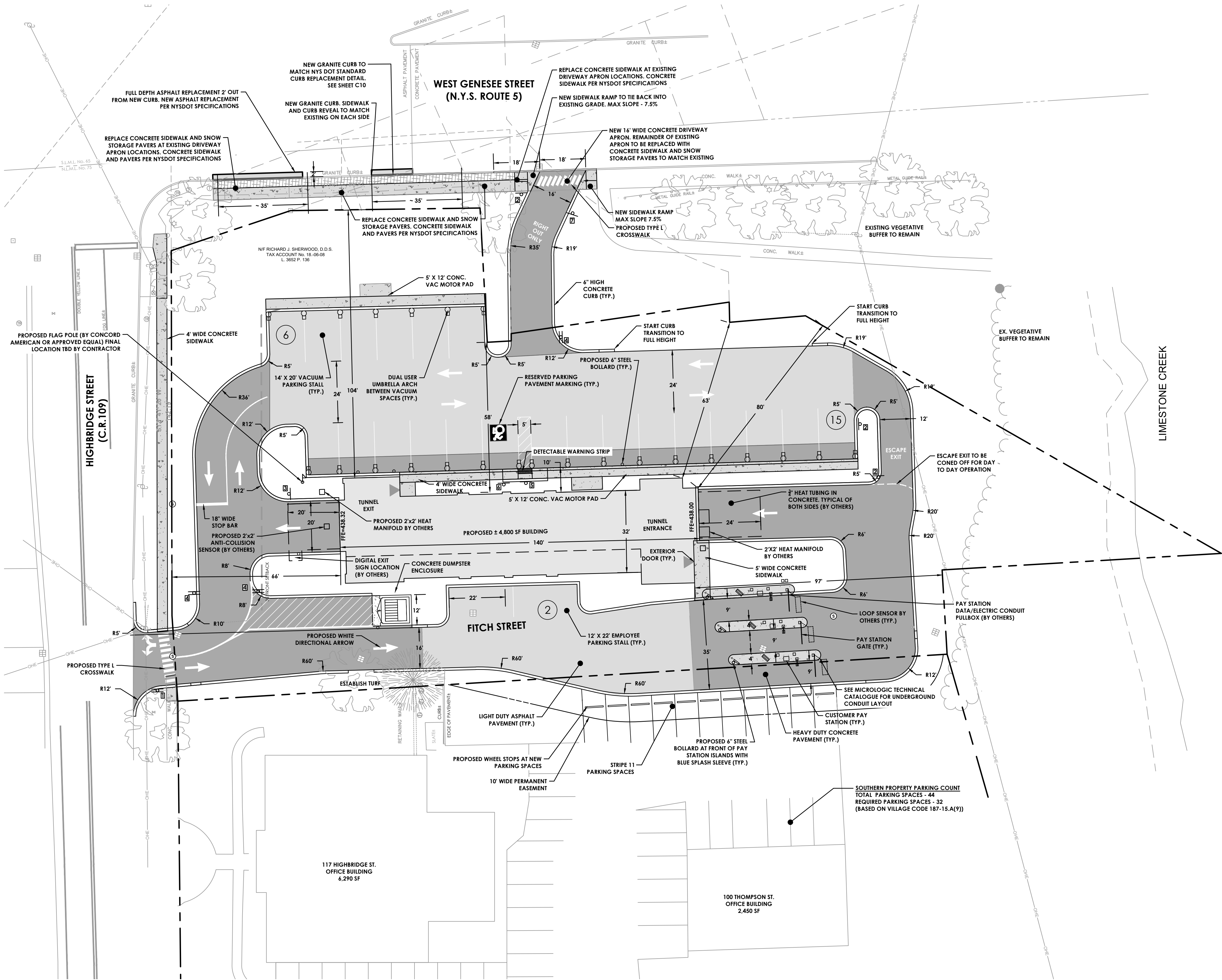

SITE DATA:

OWNER: SPLASH CAR WASH
PROJECT LOCATION: 129 W GENESEE ST, FAYETTEVILLE, NY 13066
ACCOUNT #: 018,036-9-001
TOTAL AREA: 1.14 ACRES ±
ZONING: CONTEMPORARY BUSINESS (CB)

PARKING REQUIREMENTS:

ZONING: CONTEMPORARY BUSINESS (CB)	CODE	PROPOSED
MIN. PARKING SPACE SIZE	9'X18'	9'X18', 14'X20'
SPACES:	**	2 EMPLOYEE 21 VACUUM 23 TOTAL

** "CARWASH" PARKING REQUIREMENT IS UNSPECIFIED IN VILLAGE CODE, THEREFORE, NUMBER TO BE CONSISTENT WITH NATURE OF OPERATION

ZONING REQUIREMENTS

ZONING: CONTEMPORARY BUSINESS (CB)	REQUIRED	PROPOSED
FRONT SETBACK	35'	66'
SIDE SETBACK	10'	33'
REAR SETBACK	35'	84'
MAX. BUILDING HEIGHT	35'	35'
MAX LOT COVERAGE (BUILDING)	35%	11%

AREA TABLE

APPROXIMATE AREA OF DISTURBANCE	1.28 AC
EXISTING IMPERVIOUS SURFACE	1.15 AC
PROPOSED IMPERVIOUS SURFACE	0.83 AC
PERCENT REDUCTION	27%
PERCENT GREENSPACE	27%

SIGN CALLOUT SCHEDULE

1	CAR WASH ENTER DOUBLE SIDED
2	DO NOT ENTER
3	EXIT LEFT VACUUM RIGHT
4	CAR WASH EXIT DOUBLE SIDED
5	ACCESSIBLE LOADING AREA NO PARKING
6	RESERVED PARKING
7	RIGHT TURN ONLY

NOTES:

- CONCRETE CURB TO BE USED THROUGHOUT SITE.
- PARCELS TO BE COMBINED INTO SINGLE LOT THROUGH SUBDIVISION APPLICATION.
- FITCH STREET GRANTED TO APPLICANT BY VILLAGE OF FAYETTEVILLE BOARD OF TRUSTEES AS OF OCT. 3RD, 2022.
- NO OUTSIDE PRE-WASH OR VEHICLE RINSING WILL OCCUR. ALL PRE-WASH WILL BE COMPLETED INSIDE THE BUILDING.
- SIGNS ARE SINGLE SIDED UNLESS CALLED OUT AS DOUBLE SIDED.
- CONCRETE CURB TO BE USED THROUGHOUT SITE. CURB SHOWN AS 1' WIDE FOR CLARITY. ACTUAL CURB TO BE 6" WIDE.

VILLAGE OF FAYETTEVILLE APPROVALS

PLANNING BOARD CHAIRMAN	DATE
DIRECTOR OF BUILDING & FIRE PREVENTION	DATE
FIRE MARSHAL	DATE
DIRECTOR OF ENGINEERING & PLANNING	DATE

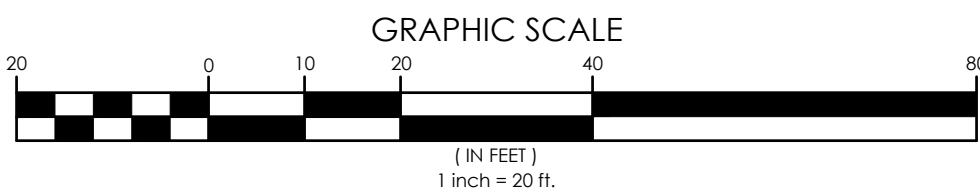

45 HENDRIX RD
WEST HENRIETTA, NY 14586
PHONE-(585)359-7540
FAX-(585)359-7541



SPLASH CAR WASH, INC
472 WHEELERS FARM RD
MILFORD, CT 06461
(585) 303 - 9448



REV	DESCRIPTION	DATE
01	REVISED PER VILLAGE FB & TOWN ENGINEER COMMENTS	8-29-22
02	REVISED PER VILLAGE FB & TOWN ENGINEER COMMENTS	9-29-22
03	REVISED PER VILLAGE FB & TOWN ENGINEER COMMENTS	10-27-22
04	REVISED PER VILLAGE FB & TOWN ENGINEER COMMENTS	11-21-22
05	REVISED PER VILLAGE FB AND NYSDOT COMMENTS	12-21-22
06	REVISED PER VILLAGE FB AND NYSDOT COMMENTS	12-21-22
07	REVISED PER VILLAGE FB AND NYSDOT COMMENTS	2-1-2023
08	REVISED PER VILLAGE FB AND NYSDOT COMMENTS	2-1-2023
09	REVISED PER VILLAGE FB AND NYSDOT COMMENTS	2-1-2023
10	EXPANDED DRIVE LANE LAYOUT (REVISED PER TOWN COMMENTS)	10-18-23

THESE DOCUMENTS INCLUDING ALL IDEAS, ARRANGEMENTS, DESIGNS AND PLANS INDICATED THEREON OR PRESENTED THEREBY ARE OWNED BY AND REMAIN THE PROPERTY OF DIG SAFELY NEW YORK. NO PART OF THESE DOCUMENTS MAY BE REPRODUCED OR TRANSMITTED IN ANY FORM OR BY ANY MEANS, ELECTRONIC OR MECHANICAL, WITHOUT THE WRITTEN PERMISSION OF DIG SAFELY NEW YORK. THE SPECIFIC WRITTEN PERMISSION OF DDS COMPANIES. ALL RIGHTS RESERVED. ©

129 W GENESEE STREET
SPLASH CAR WASH
VILLAGE OF FAYETTEVILLE, ONONDAGA COUNTY, NEW YORK

SITE PLAN

REV: 10	DRAWING NO: C3
---------	----------------

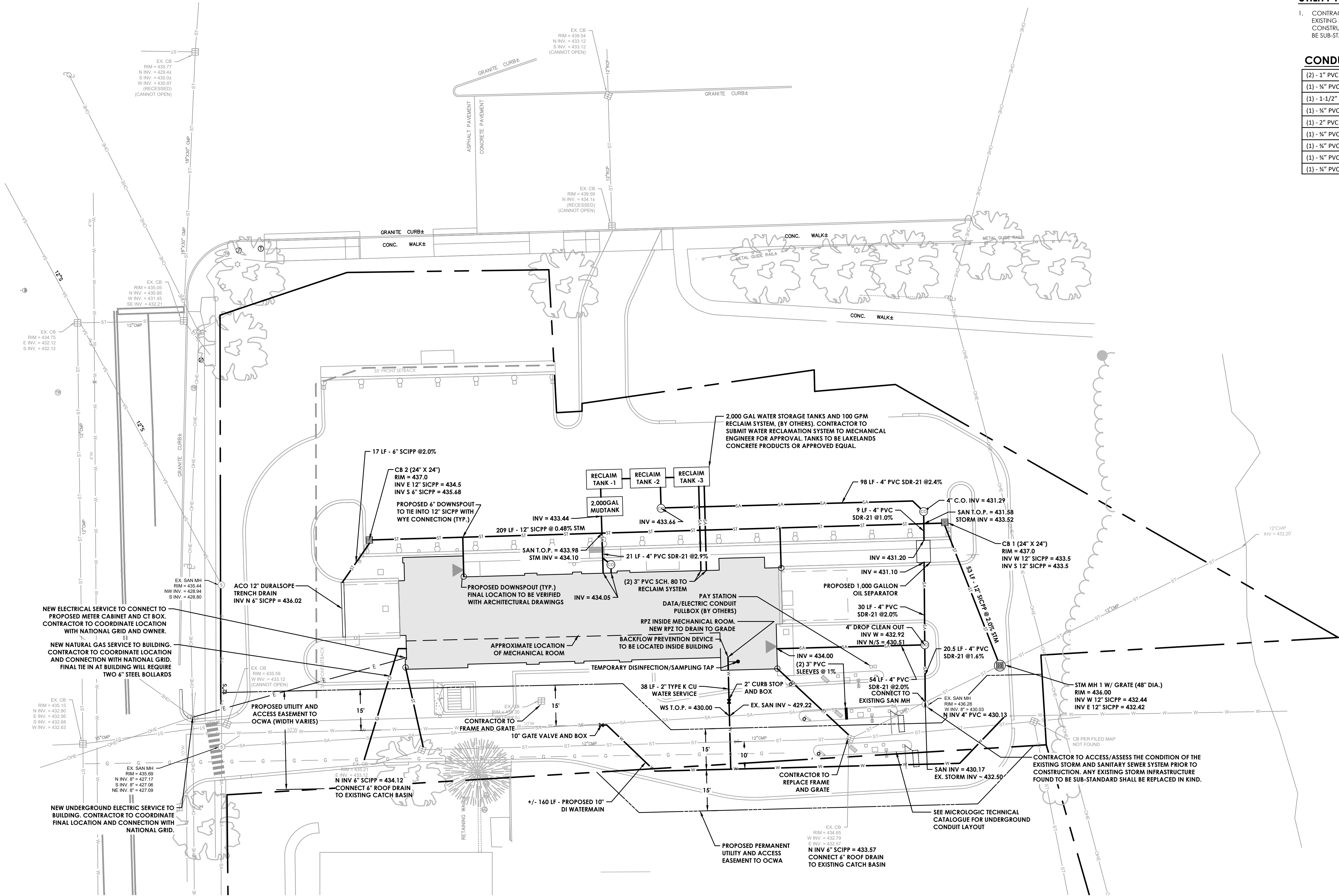

UTILITY NOTE:

1. CONTRACTOR TO ACCESS/ASSESS THE CONDITION OF THE EXISTING STORM AND SANITARY SEWER SYSTEM PRIOR TO CONSTRUCTION. ANY EXISTING STORM INFRASTRUCTURE FOUND TO BE SUB-STANDARD SHALL BE REPLACED IN KIND.

CONDUIT SCHEDULE

(2) - 1" PVC CONDUITS FOR TRANSDUCERS AT BOTH VACUUM AREAS
(1) - 3/4" PVC CONDUIT FOR EXIT GATE
(1) - 1-1/2" PVC CONDUIT FOR VACUUM LIGHTS
(1) - 3/4" PVC CONDUIT FOR STOP/GO LIGHTS
(1) - 2" PVC CONDUIT FROM UTILITY ROOM TO COMM UTILITY POLE
(1) - 3/4" PVC CONDUIT FOR FREE AIR MACHINE
(1) - 3/4" PVC CONDUIT FOR ANTI-COLLISION PAD
(1) - 3/4" PVC CONDUIT FOR PAY ISLAND LIGHTING
(1) - 3/4" PVC CONDUIT FOR FLAG POLE LIGHTING

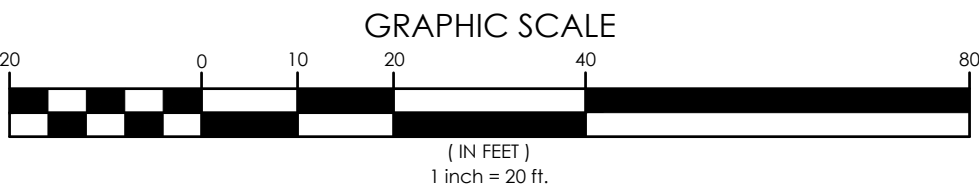

Dig Safely.
New York
1-800-962-7962
www.digsafelynewyork.org
Call Before You Dig
Wait The Required Time
Confirm Utility Response
Respect the Marks
Dig With Care



45 HENDRIX RD
WEST HENRIETTA, NY 14586
PHONE-(585)359-7540
FAX-(585)359-7541



SPLASH CAR WASH, INC
472 WHEELERS FARM RD
MILFORD, CT 06461
(585) 303 - 9448



REV	DESCRIPTION	DATE
01	REVISED PER VILLAGE FB & TOWN ENGINEER COMMENTS	8-29-22
02	REVISED PER VILLAGE FB & TOWN ENGINEER COMMENTS	9-29-22
03	REVISED PER VILLAGE FB & TOWN ENGINEER COMMENTS	10-27-22
04	REVISED PER VILLAGE FB & TOWN ENGINEER COMMENTS	11-21-22
05	REVISED PER VILLAGE FB AND TOWN ENGINEER COMMENTS	12-21-22
06	REVISED PER VILLAGE FB AND TOWN ENGINEER COMMENTS	1-11-23
07	REVISED PER VILLAGE FB AND TOWN ENGINEER COMMENTS	2-1-2023
08	REVISED PER VILLAGE FB AND TOWN ENGINEER COMMENTS	2-13-23
09	REVISED PER VILLAGE FB AND TOWN ENGINEER COMMENTS	2-13-23
10	EXPANDED DRIVE LANE LAYOUT (REVISED PER TOWN COMMENTS)	10-18-23

129 W GENESEE STREET
SPLASH CAR WASH
VILLAGE OF FAVETTEVILLE, ONONDAGA COUNTY, NEW YORK

UTILITY PLAN

REV: 10	DRAWING NO: C4
---------	----------------

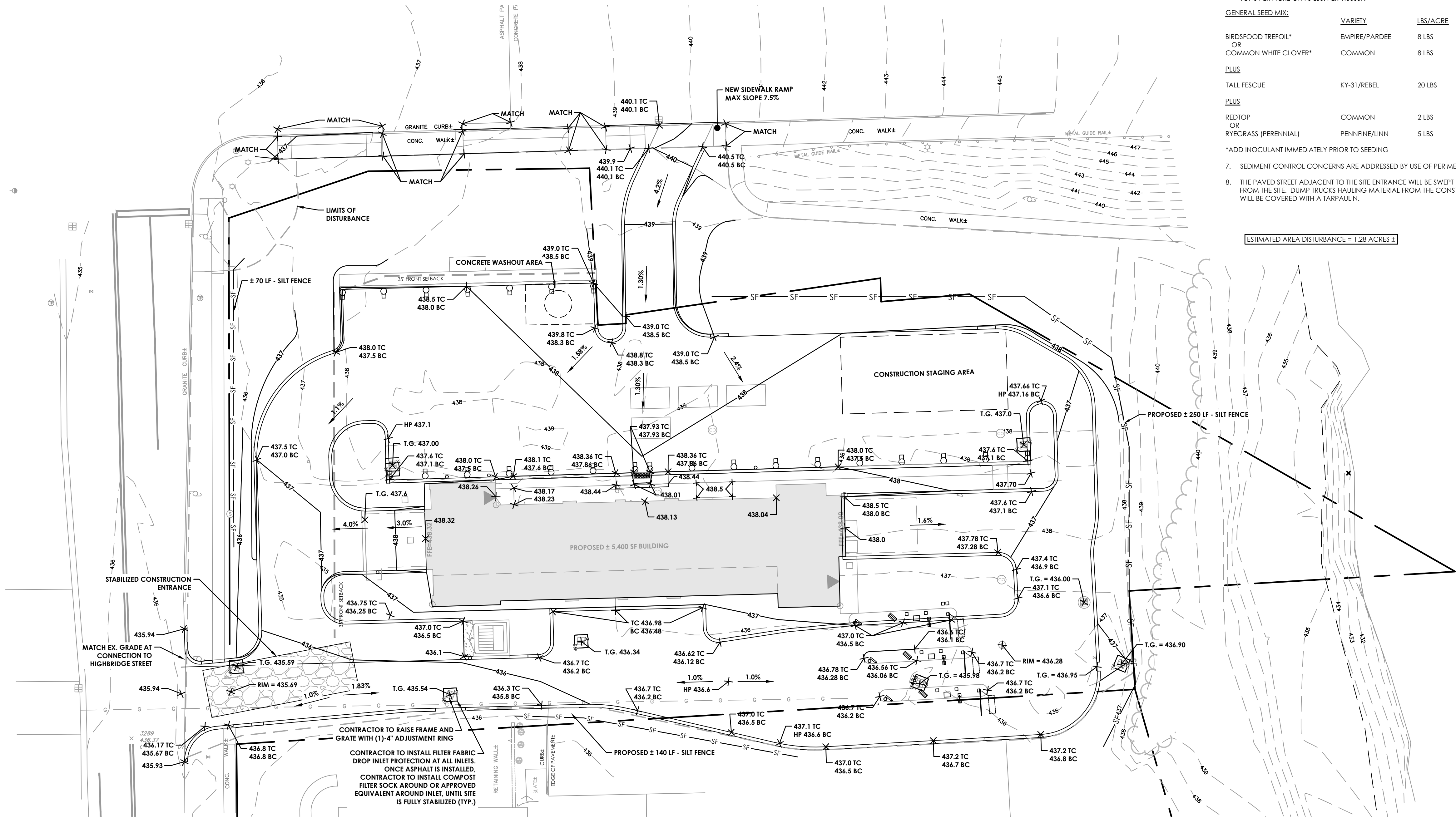

EROSION & SEDIMENT CONTROLS

1. PROCEDURES OUTLINED IN THE NEW YORK STATE STANDARDS AND SPECIFICATIONS FOR EROSION AND SEDIMENT CONTROL MUST BE FOLLOWED THROUGHOUT THE DURATION OF CONSTRUCTION OF THIS PROJECT. THROUGHOUT CONSTRUCTION, EMPHASIS WILL BE PLACED ON PREVENTING EROSION OF THE DISTURBED AND EXPOSED SOIL WITHIN THE SITE.
2. VEGETATIVE MEASURES SUCH AS JUTE MESH, SEEDING AND MULCHING WILL BE UTILIZED TO HELP PREVENT ERODING OF THE SOIL. JUTE MESH SHALL BE USED ON ALL SLOPES OF 1V:3H AND STEEPER.
3. BARE SOIL WILL BE SEEDED WITHIN 14 DAYS OF EXPOSURE UNLESS CONSTRUCTION WILL BEGIN WITHIN 21 DAYS. IF CONSTRUCTION IS SUSPENDED, OR SECTIONS COMPLETED, AREAS WILL BE SEEDED OR MULCHED IMMEDIATELY.
4. TEMPORARY SEEDING WILL CONSIST OF RYEGRASS PLACED AT A RATE OF 30 LBS. PER ACRE OR 0.7 LBS. PER 1,000SF. THE AREA IS TO THEN BE MULCHED WITH HAY OR STRAW AT A RATE OF 2 TONS PER ACRE OR 90 LBS. PER 1,000SF.
5. TOPSOIL SHALL BE PLACED AT A DEPTH OF 6" MINIMUM.
6. PERMANENT SEEDING SHALL FOLLOW THE CHART LISTED BELOW. MULCH SHALL BE SMALL GRAIN STRAW APPLIED AT A RATE OF 2 TONS PER ACRE OR 90 LBS. PER 1,000SF.

GENERAL SEED MIX:	VARIETY	LBS/ACRE	LBS/1,000SF
BIRDSFOOD TREFOIL* OR COMMON WHITE CLOVER*	EMPIRE/PARDEE COMMON	8 LBS 8 LBS	0.20 LBS 0.20 LBS
PLUS			
TALL FESCUE	KY-31/REBEL	20 LBS	0.45 LBS
PLUS			
REDTOP OR RYEGRASS (PERENNIAL)	COMMON PENNFINE/LINN	2 LBS 5 LBS	0.05 LBS 0.10 LBS

- *ADD INOCULANT IMMEDIATELY PRIOR TO SEEDING
7. SEDIMENT CONTROL CONCERNS ARE ADDRESSED BY USE OF PERIMETER CONTROLS SUCH AS SILT FENCE AND STONE CHECK DAMS.
 8. THE PAVED STREET ADJACENT TO THE SITE ENTRANCE WILL BE SWEEPED DAILY TO REMOVE ANY EXCESS MUD, DIRT OR ROCK TRACKED FROM THE SITE. DUMP TRUCKS HAULING MATERIAL FROM THE CONSTRUCTION SITE WHICH IS PRONE TO BLOWING FROM THE WIND WILL BE COVERED WITH A TARPULIN.

ESTIMATED AREA DISTURBANCE = 1.28 ACRES ±

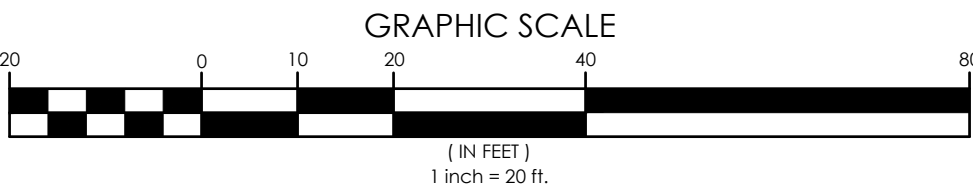

45 HENDRIX RD
WEST HENRIETTA, NY 14586
PHONE-(585)359-7540
FAX-(585)359-7541



SPLASH CAR WASH, INC
472 WHEELERS FARM RD
MILFORD, CT 06461
(585) 303 - 9448



REV	DESCRIPTION	DATE
01	REVISED PER VILLAGE PB & TOWN ENGINEER COMMENTS	8-29-22
02	REVISED PER VILLAGE PB & TOWN ENGINEER COMMENTS	9-29-22
03	REVISED PER VILLAGE PB & TOWN ENGINEER COMMENTS	10-27-22
04	REVISED PER VILLAGE PB & TOWN ENGINEER COMMENTS	11-21-22
05	REVISED PER VILLAGE PB AND NYSDOT COMMENTS	12-21-22
06	REVISED PER VILLAGE PB AND NYSDOT COMMENTS	2-1-23
07	REVISED PER DOT COMMENTS	2-1-2023
08	REVISED PER DOT COMMENTS	2-1-23
09	REVISED PER DOT COMMENTS	2-1-23
10	EXPANDED DRIVE LANE LAYOUT (REVISED PER TOWN COMMENTS)	10-18-23

THESE DOCUMENTS INCLUDING ALL IDEAS, ARRANGEMENTS, DESIGNS AND PLANS INDICATED THEREON OR PRESENTED THEREBY ARE OWNED BY AND REMAIN THE PROPERTY OF DIG SAFELY NEW YORK. NO PART OF THESE DOCUMENTS MAY BE REPRODUCED OR TRANSMITTED IN ANY FORM OR BY ANY MEANS, ELECTRONIC OR MECHANICAL, WITHOUT THE WRITTEN PERMISSION OF DIG SAFELY NEW YORK. THE SPECIFIC WRITTEN PERMISSION OF DDS COMPANIES. ALL RIGHTS RESERVED. ©

129 W GENESEE STREET
SPLASH CAR WASH
VILLAGE OF FAVETTEVILLE, ONONDAGA COUNTY, NEW YORK

GRADING PLAN

DRAWING TITLE:

DRAWN BY:	SHC	APPROVED BY:	ESM	PROJ. NO.:	72220023
CHECKED BY:	CAK	DATE:	6-24-22	PAGE SIZE:	ANSI D

REV: 10

DRAWING NO: C5

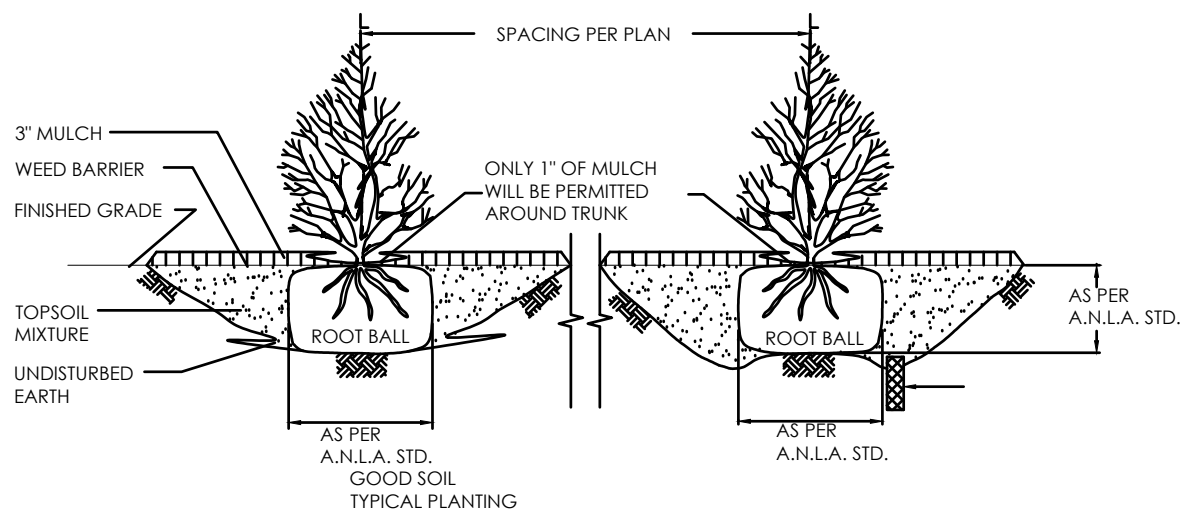
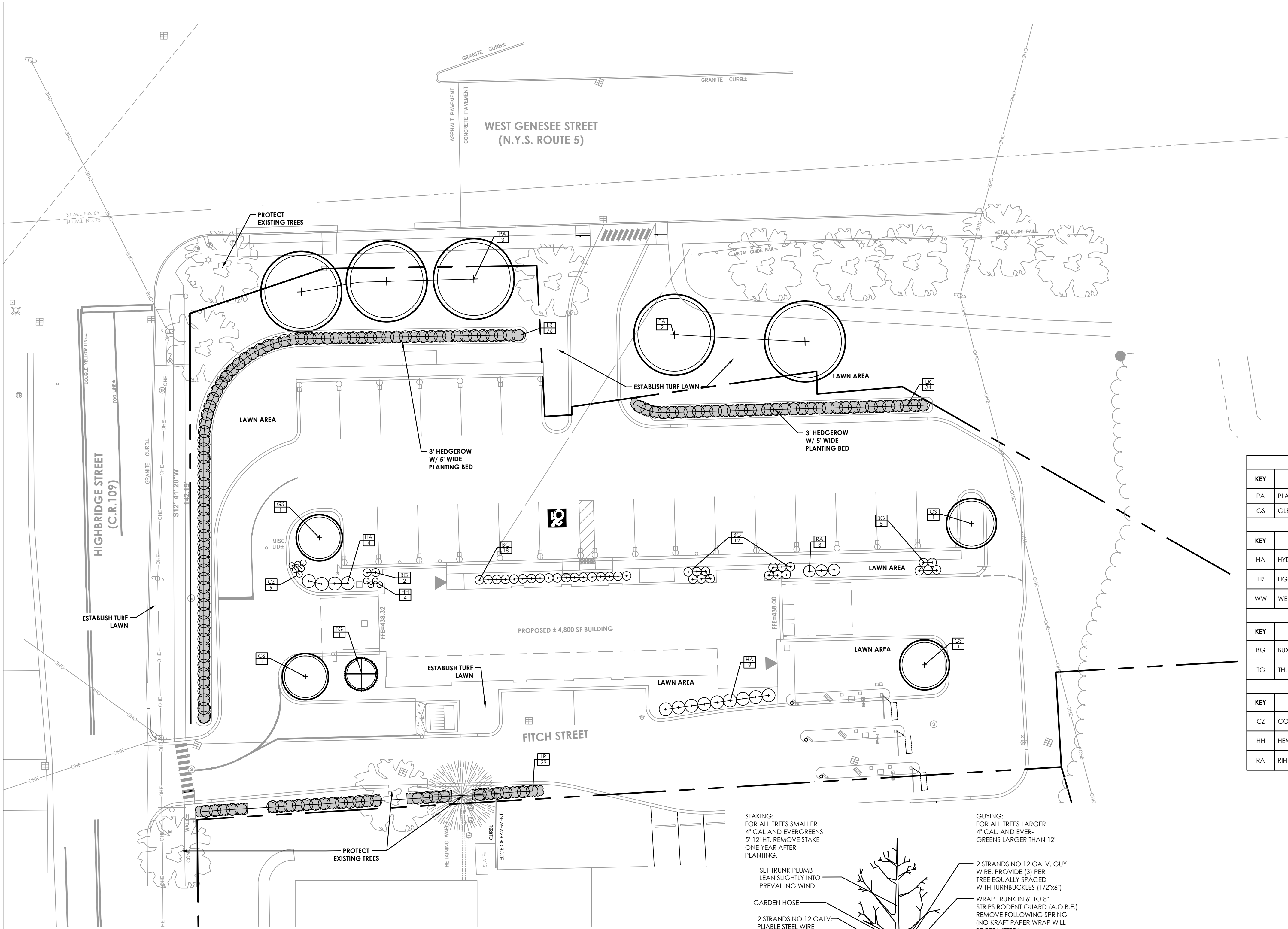

SHRUB PLANTING DETAIL
N.T.S.

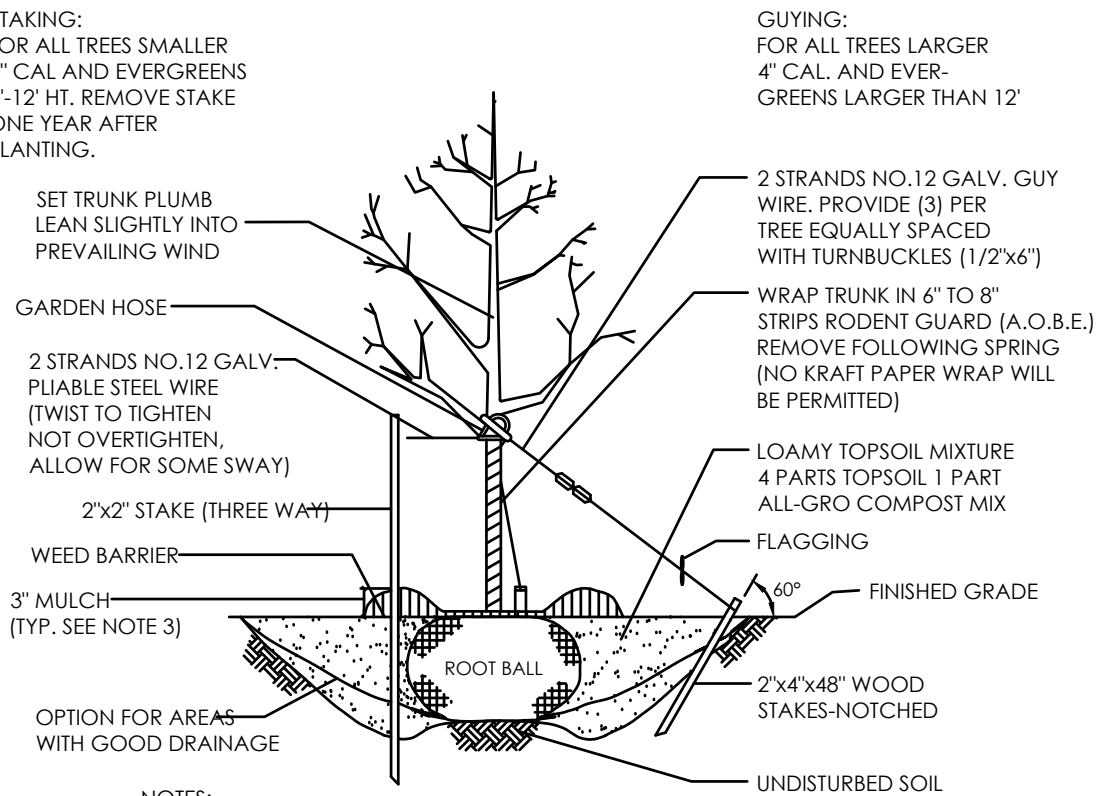

TREE PLANTING DETAIL
N.T.S.

PLANTING LEGEND

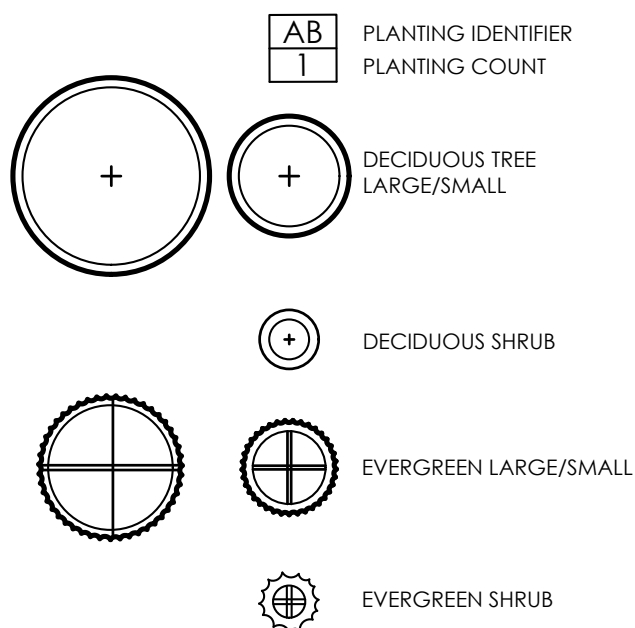

VILLAGE OF FAYETTEVILLE APPROVALS

PLANNING BOARD CHAIRMAN _____ DATE _____

DIRECTOR OF BUILDING & FIRE PREVENTION _____ DATE _____

FIRE MARSHAL _____ DATE _____

DIRECTOR OF ENGINEERING & PLANNING _____ DATE _____

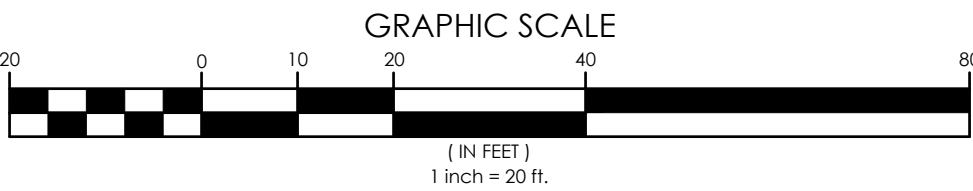

PLANTING NOTES

- MULCH AROUND INDIVIDUAL PLANTS ONLY. SHREDDED HARDWOOD MULCH IS THE ONLY ACCEPTED MULCH. PINE MULCH AND WOOD CHIPS WILL FLOAT AND MOVE TO THE PERIMETER OF THE PRETREATMENT AREA DURING A STORM EVENT AND ARE NOT ACCEPTABLE. SHREDDED MULCH MUST BE WELL AGED (6 TO 12 MONTHS) FOR ACCEPTANCE.
- THE PLANT ROOT BALL SHOULD BE PLANTED SO 1/8TH OF THE BALL IS ABOVE FINAL GRADE SURFACE.
- ROOT STOCK OF THE PLANT MATERIAL SHALL BE KEPT MOIST DURING TRANSPORT AND ON-SITE STORAGE. THE DIAMETER OF THE PLANTING PIT SHALL BE AT LEAST SIX INCHES LARGER THAN THE DIAMETER OF THE PLANTING BALL. SET AND MAINTAIN THE PLANT STRAIGHT DURING THE ENTIRE PLANTING PROCESS. THOROUGHLY WATER GROUND BED COVER AFTER INSTALLATION.
- TREES SHALL BE BRACED USING 2" X 2" STAKES ONLY AS NECESSARY AND FOR THE FIRST GROWING SEASON ONLY. STAKES ARE TO BE EQUALLY SPACED ON THE OUTSIDE OF THE TREE BALL.
- GRASSES AND LEGUME SEED SHALL BE TILLED INTO THE SOIL TO A DEPTH OF AT LEAST ONE INCH. GRASS AND LEGUME PLUGS SHALL BE PLANTED FOLLOWING THE NON-GRASS GROUND COVER PLANTING SPECIFICATIONS.
- ALL DISTURBED UNSURFACED AREAS SHALL RECEIVE MIN. SIX INCHES OF TOPSOIL, SEED AND MULCH AND SHALL BE WATERED UNTIL A HEALTHY STAND OF GRASS IS OBTAINED.
- NO IRRIGATION SYSTEM TO BE INSTALLED. CONTRACTOR SHALL PROVIDE HARDY TREES SUITABLE FOR USE IN THE SOIL AND CLIMATE CONDITIONS OF THE PROJECT, AND PROVIDE THE OWNER WITH A BONDED WRITTEN ONE-YEAR MAINTENANCE/WARRANTY AGREEMENT PER THE SPECIFICATIONS.

PLANT LIST						
DECIDUOUS TREES						
KEY	BOTANICAL NAME	COMMON NAME	QUANTITY	SIZE	ROOT	REMARKS
PA	PLATANUS ACER 'EXCLAMATION'	EXCLAMATION LONDON PLANE TREE	5	2 1/2 - 3" CAL.	B&B	-
GS	GLEDITSIA TRIA, 'DINER', 'STREET KEEPER'	STREET KEEPER HONEY LOCUST	4	2 1/2 - 3" CAL.	B&B	-
DECIDUOUS SHRUBS						
KEY	BOTANICAL NAME	COMMON NAME	QUANTITY	SIZE	ROOT	REMARKS
HA	HYDRANGEA ARB. 'ANNABELLE'	ANNABELLE HYDRANGEA	13	24 - 30" HT.	#5 CONT.	-
LR	LIGUSTRUM AMURENSE	AMUR PRIVET	139	30" HT.	B&B	4' O.C.
WW	WEIGELA FLOR. 'WINE AND ROSES'	WINE AND ROSES WEIGELA	5	30" HT.	#5 CONT.	4' O.C.
EVERGREEN SHRUBS						
KEY	BOTANICAL NAME	COMMON NAME	QUANTITY	SIZE	ROOT	REMARKS
BG	BUXUS X. 'GREEN VELVET'	GREEN VELVET BOXWOOD	37	18" SPR.	#3 CONT.	5' O.C.
TG	THUJA PLICATA 'GREEN GIANT'	GREEN GIANT CEDAR	1	7'-8'	B&B	-
GRASS AND PERENNIALS						
KEY	BOTANICAL NAME	COMMON NAME	QUANTITY	SIZE	ROOT	REMARKS
CZ	COREOPSIS VERT. 'ZAGREB'	ZAGREB COREOPSIS	9	#2 CONT.	CLUMP	-
HH	HEMEROCALLIS 'HAPPY RETURNS'	HAPPY RETURNS DAYLILY	4	#2 CONT.	CLUMP	-
RA	RIHUS AROMATICA 'GRO-LOW'	GRO-LOW SUMAC	4	18" SPR..	#3 CONT.	HEAVY



45 HENDRIX RD
WEST HENRIETTA, NY 14586
PHONE-(585)359-7540
FAX-(585)359-7541



SPLASH CAR WASH, INC
472 WHEELERS FARM RD
MILFORD, CT 06461
(860) 303 - 9448



HEINRICH W. FISCHER, R.L.A.

DATE	DESCRIPTION	REV
8-29-22	REVISED PER VILLAGE PB & TOWN ENGINEER COMMENTS	01
9-29-22	REVISED PER VILLAGE PB & TOWN ENGINEER COMMENTS	02
10-27-22	REVISED PER VILLAGE PB & TOWN ENGINEER COMMENTS	03
11-21-22	REVISED PER VILLAGE PB & TOWN ENGINEER COMMENTS	04
12-21-22	REVISED PER VILLAGE PB AND NYSEDOT COMMENTS	05
1-21-23	REVISED PER NYSEDOT COMMENTS	06
2-13-23	REVISED PER NYSEDOT COMMENTS	07
2-13-23	REVISED PER NYSEDOT COMMENTS	08
2-13-23	REVISED PER NYSEDOT COMMENTS	09
10-19-23	EXPANDED DRIVE LANE LAYOUT (REVISED PER TOWN COMMENTS)	10

129 W GENESEE STREET
SPLASH CAR WASH
VILLAGE OF FAYETTEVILLE, ONONDAGA COUNTY, NEW YORK

DRAWING TITLE: LANDSCAPE PLAN

DATE: 6-24-22

PROJ. NO.: 72220023

ESM APPROVED BY: _____

SJC APPROVED BY: _____

CAC DATE: _____

ANSI D

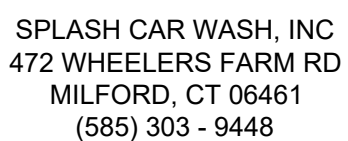
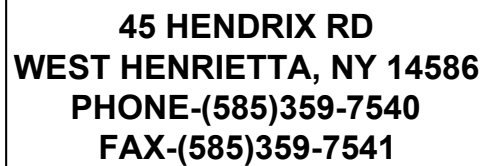
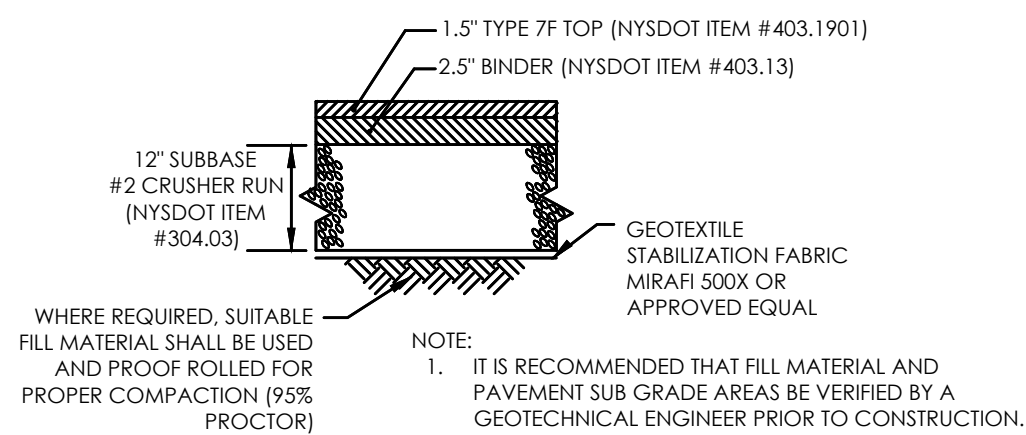
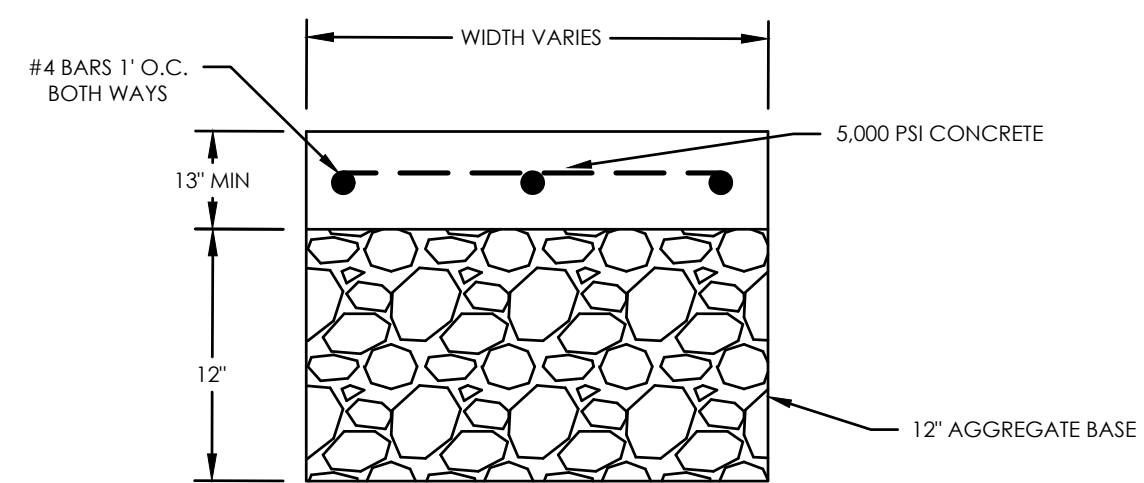
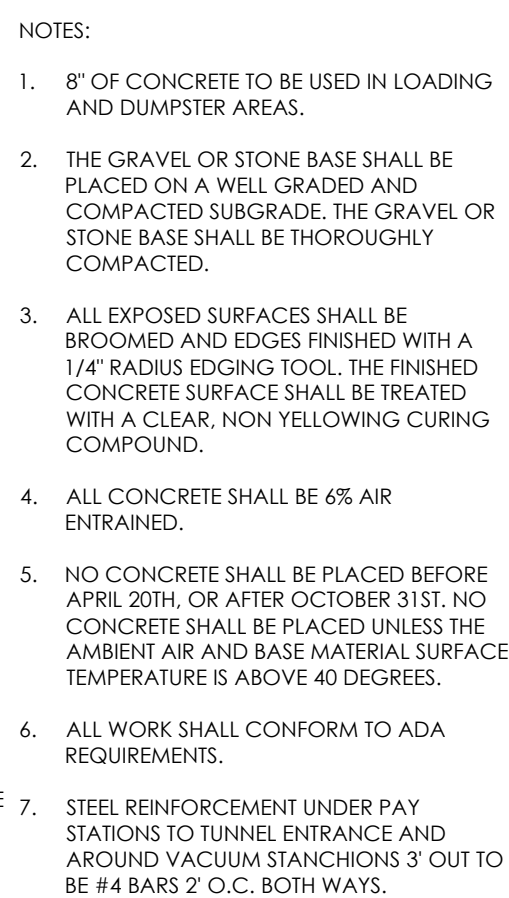
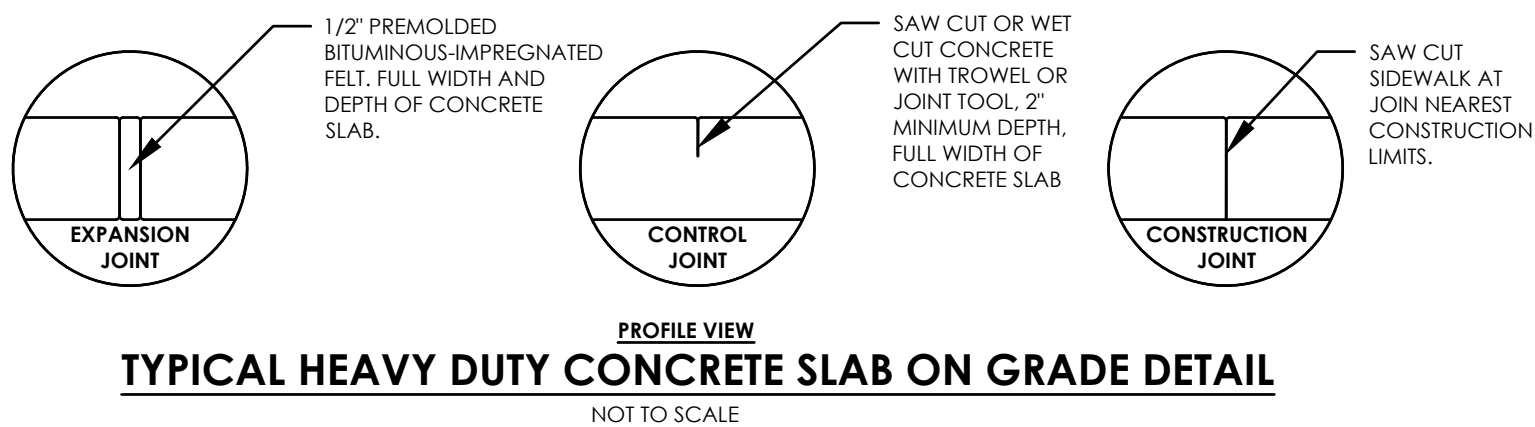
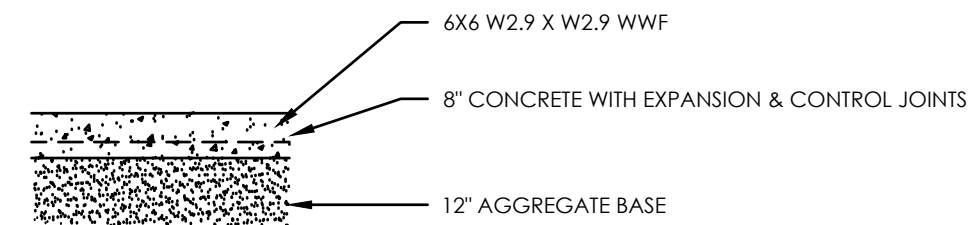
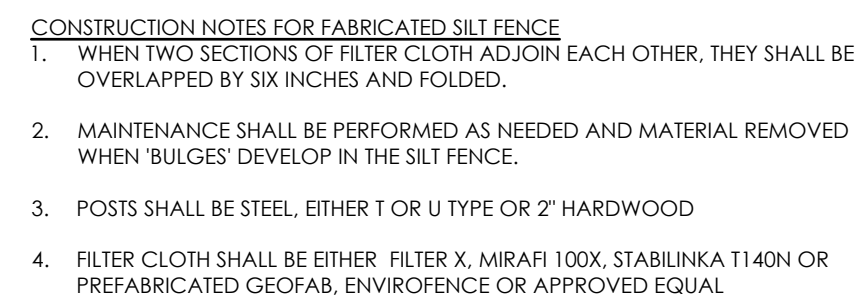
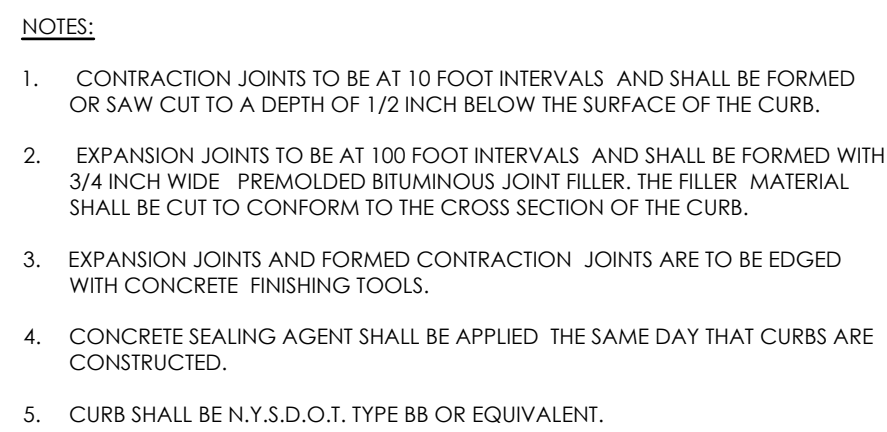
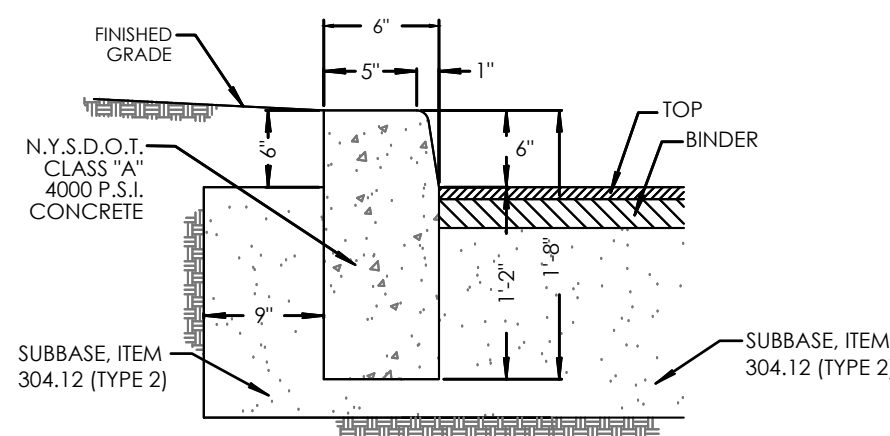
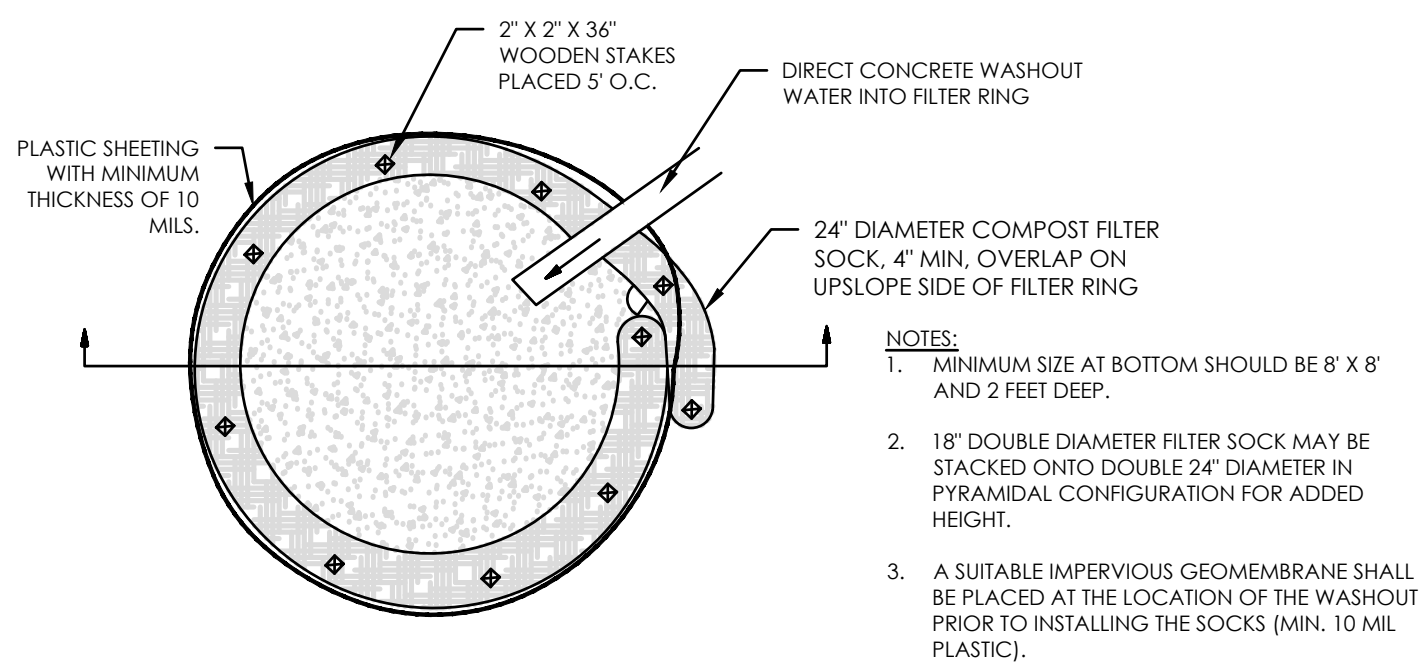
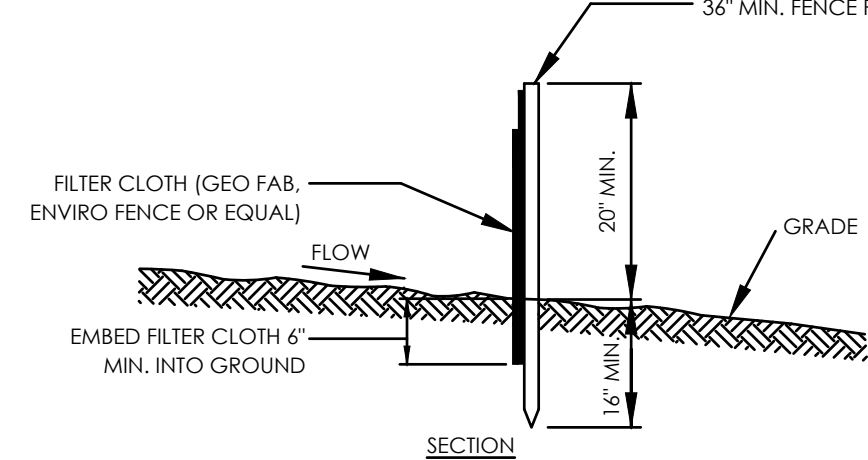
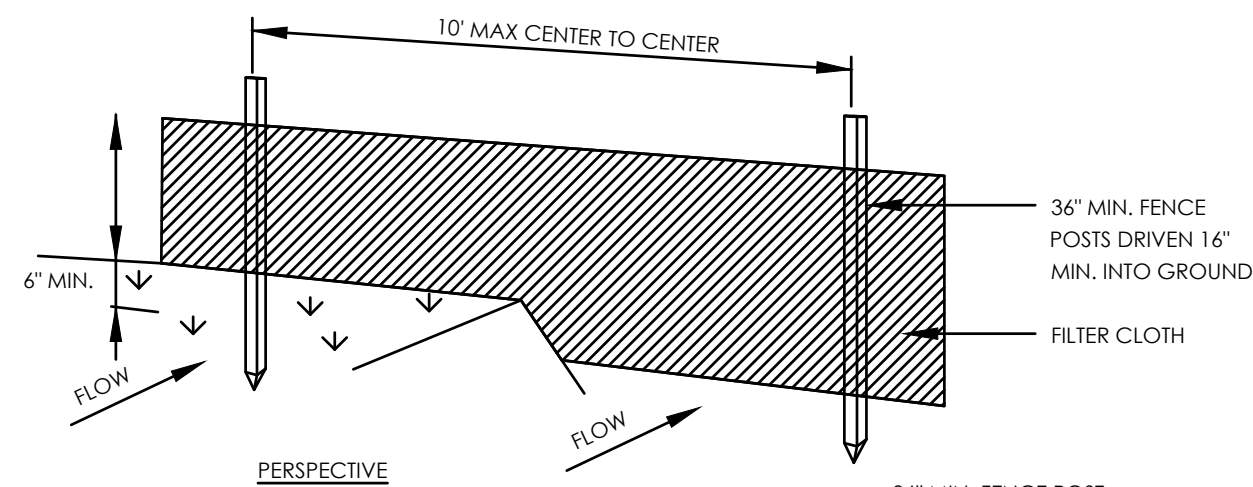
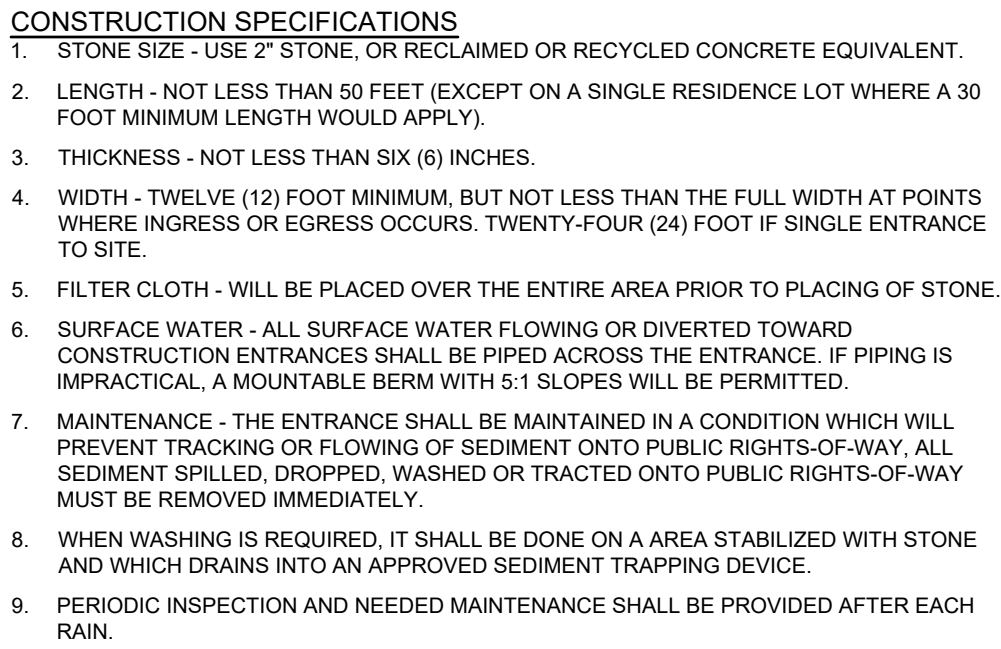
[illegible]

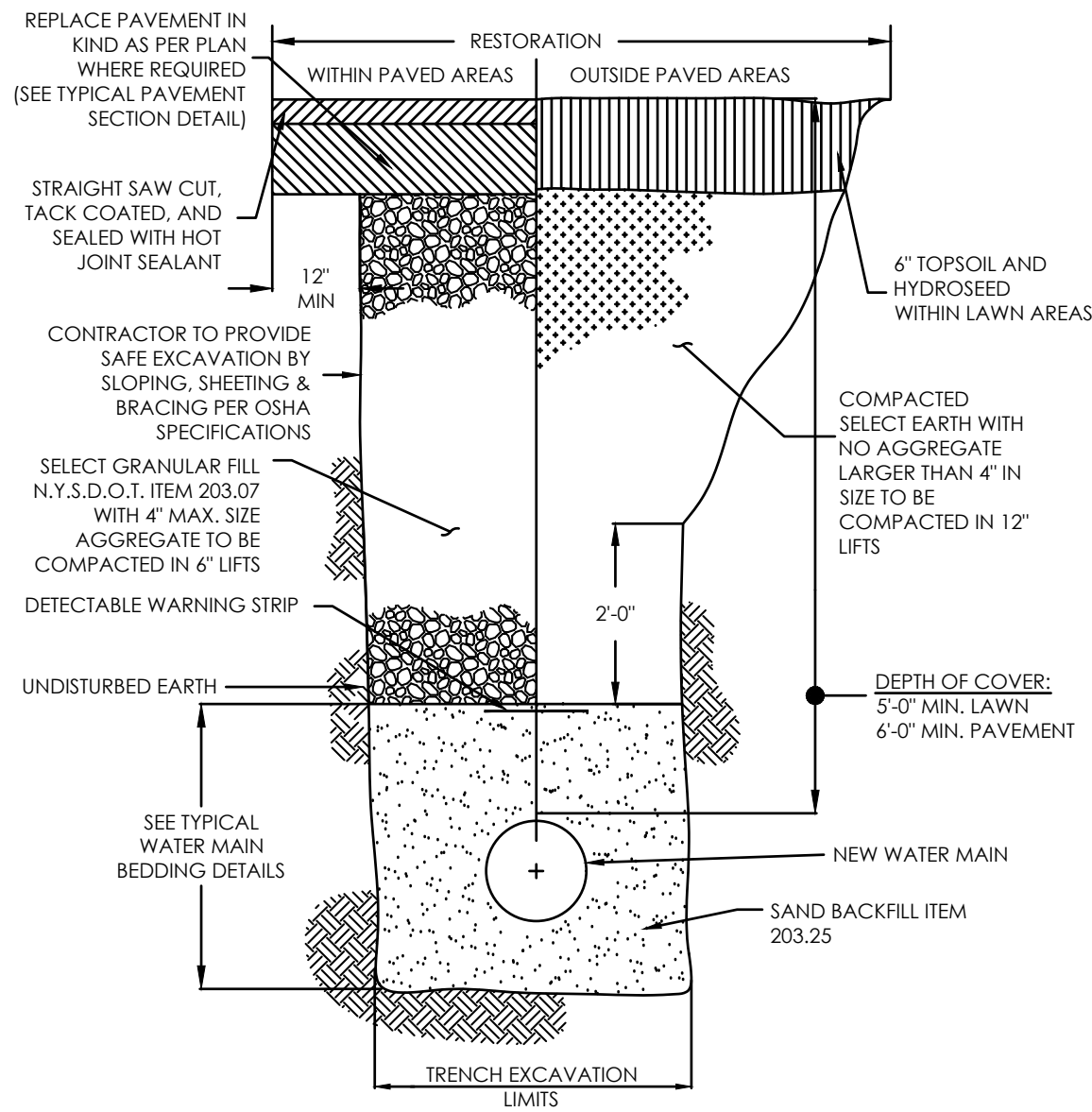

WATERMAIN TRENCH DETAIL
NOT TO SCALE

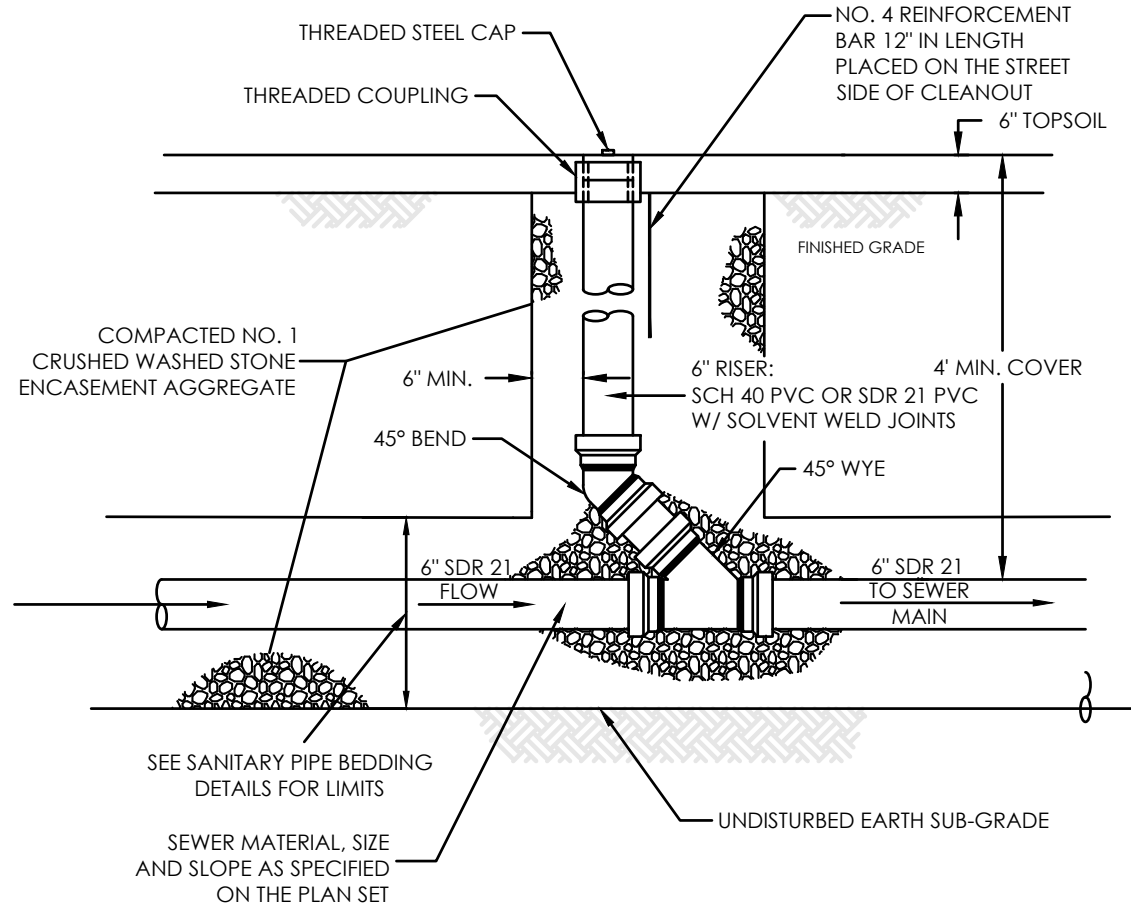

SANITARY LATERAL CLEANOUT
NOT TO SCALE

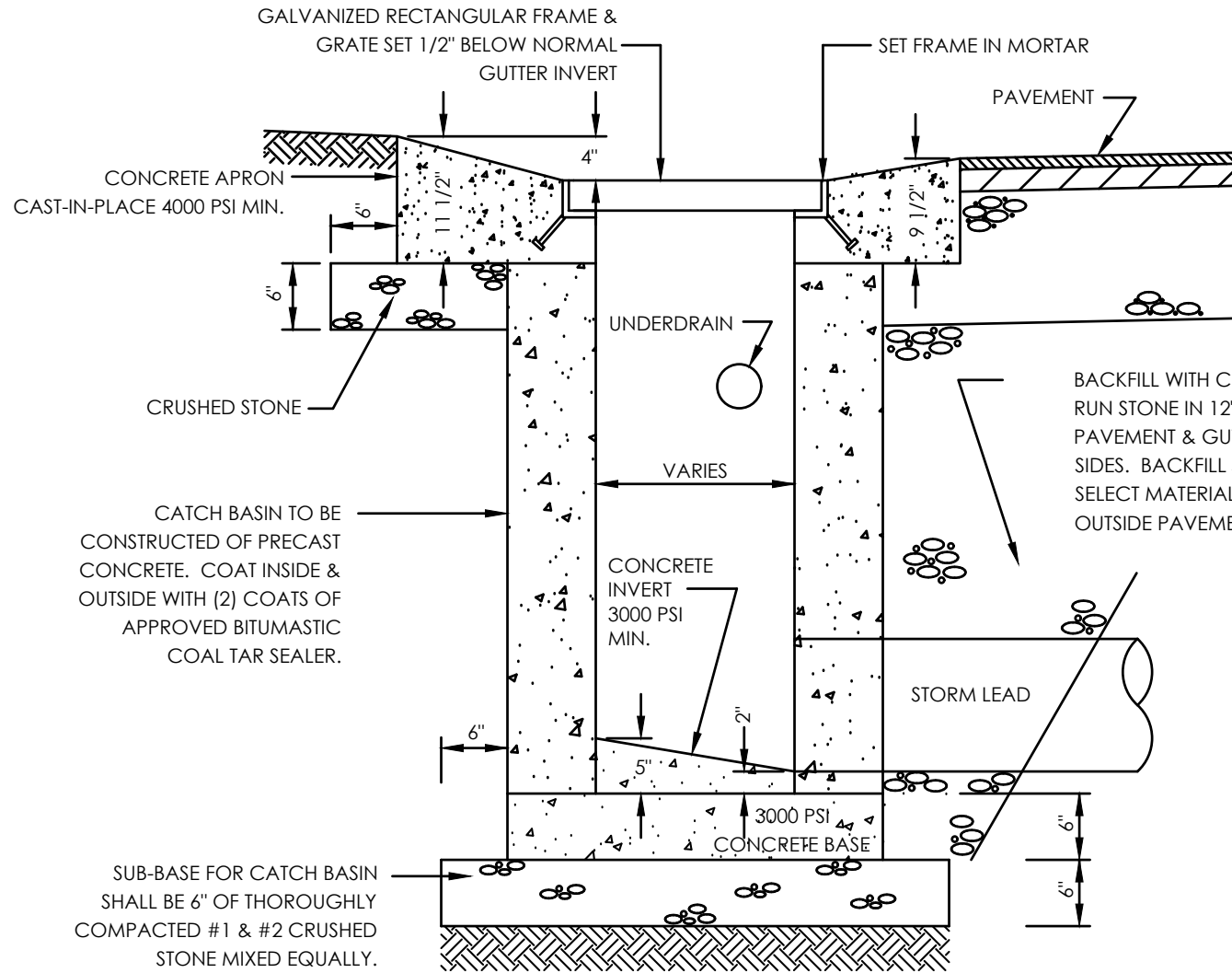

CATCH BASIN DETAIL
NOT TO SCALE

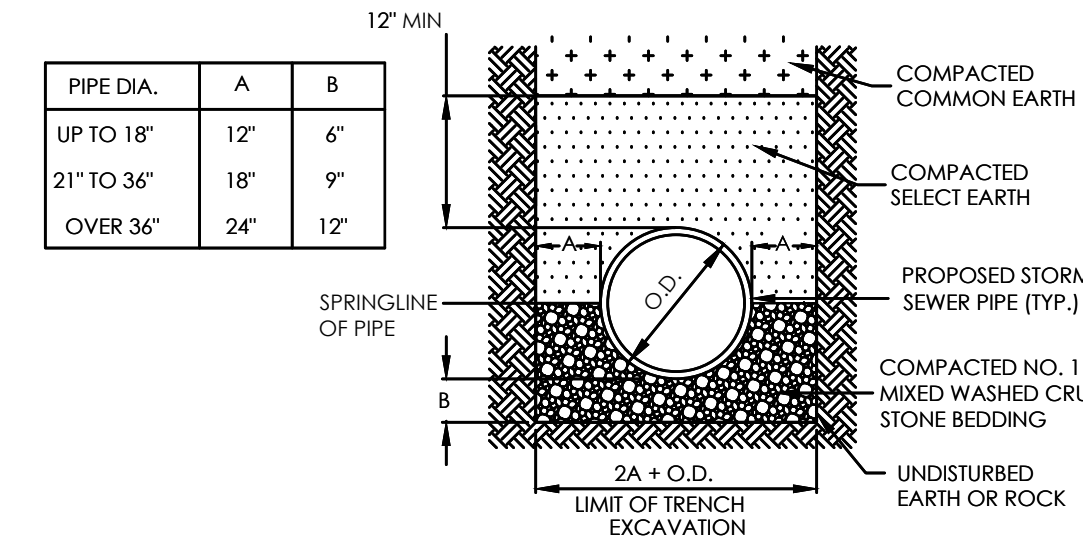

TYPICAL STORM BEDDING DETAIL
NOT TO SCALE

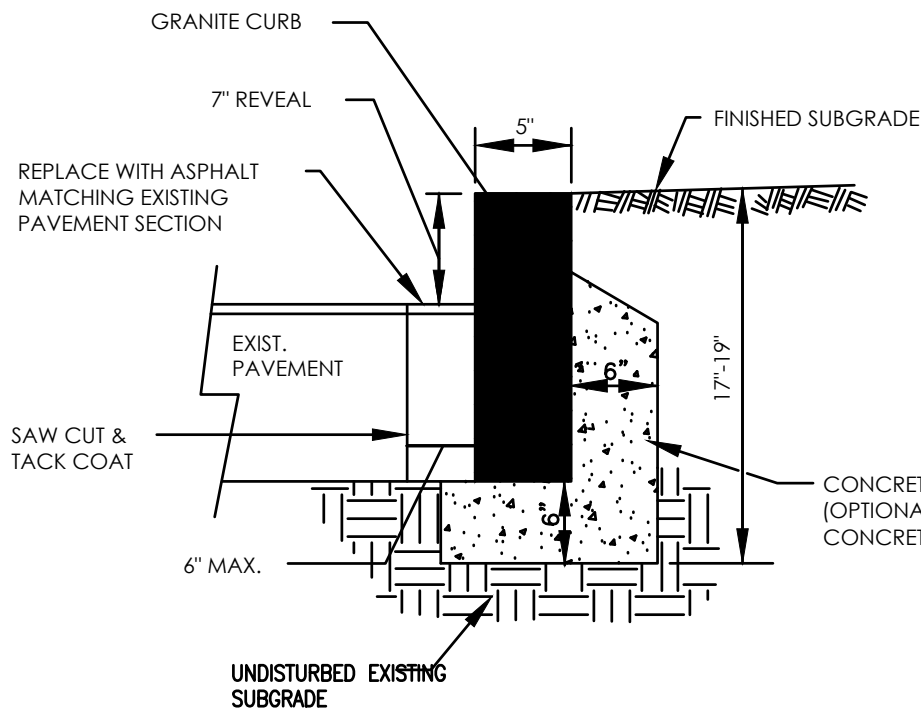

GRANITE CURB DETAIL
NOT TO SCALE

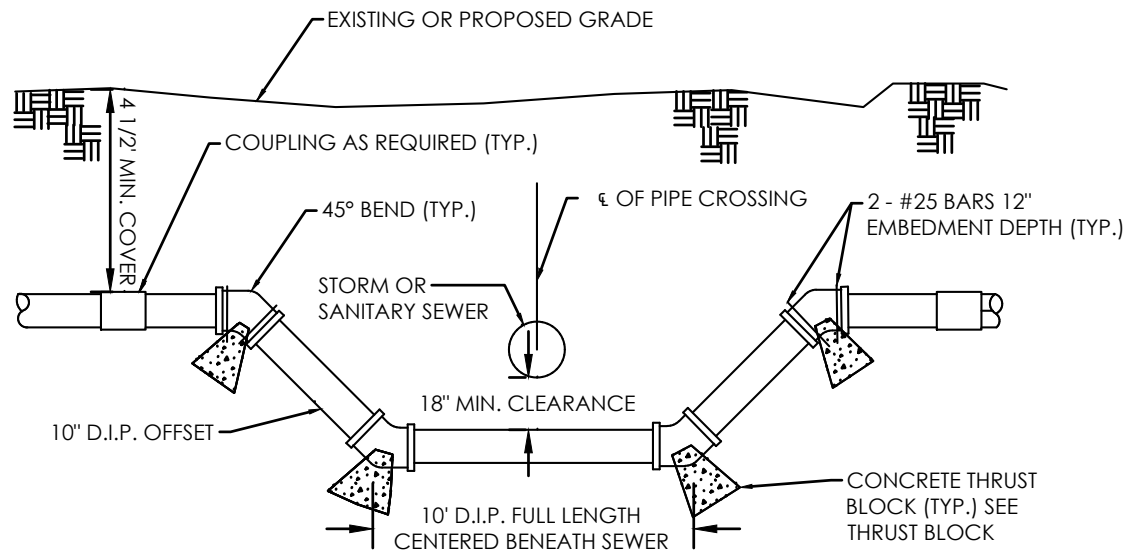

WATERMAIN - SEWER CROSSING
NOT TO SCALE

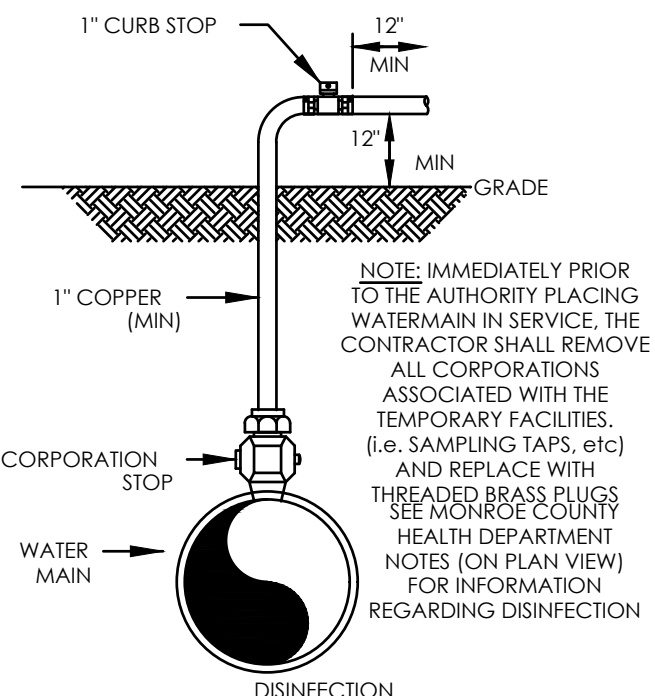

DISINFECTION/BLOW OFF/SAMPLING TAP (TEMPORARY)
NOT TO SCALE

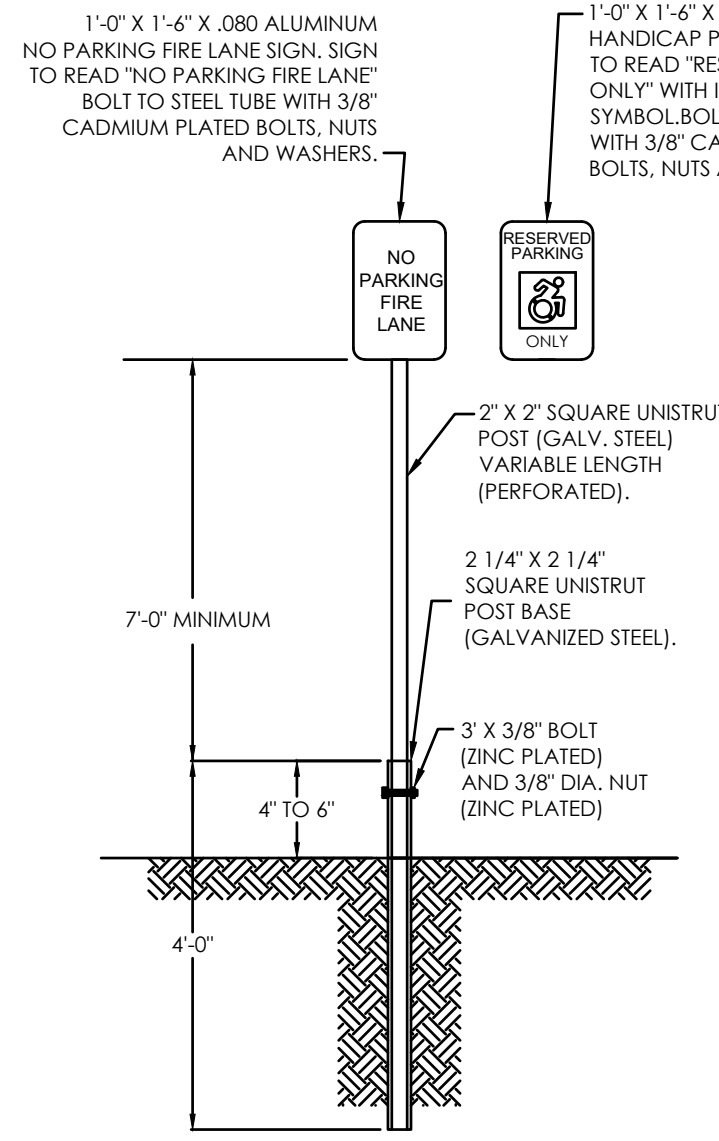

SIGN INSTALLATION DETAIL
NOT TO SCALE

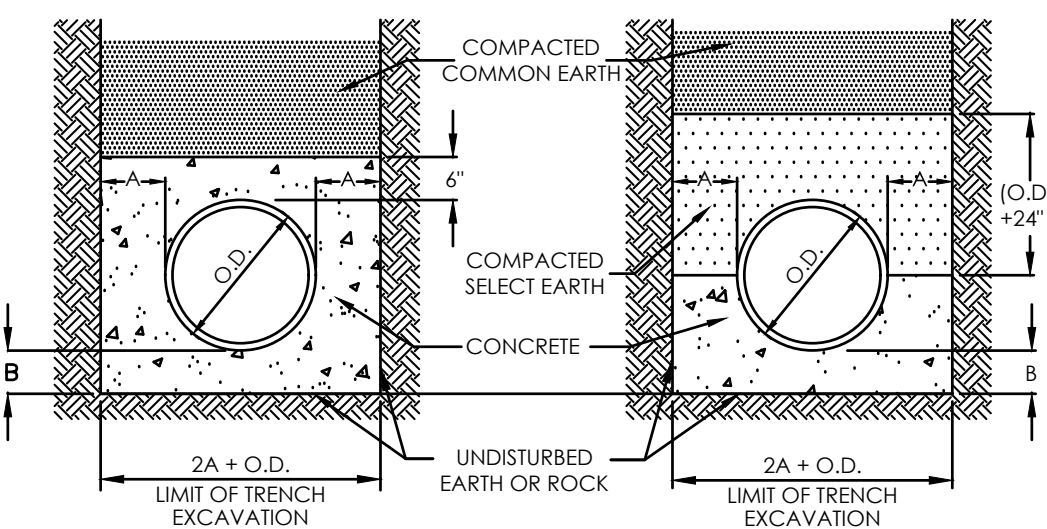

CONCRETE ENCASEMENT
CONCRETE CRADLE

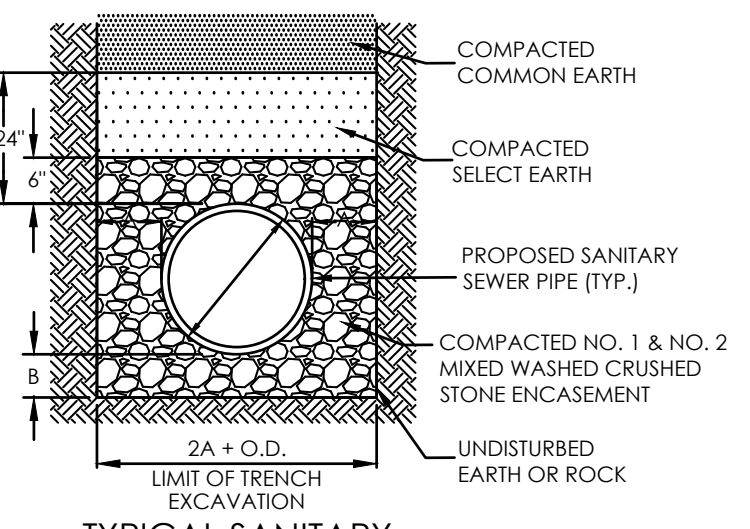

TYPICAL SANITARY BEDDING DETAIL

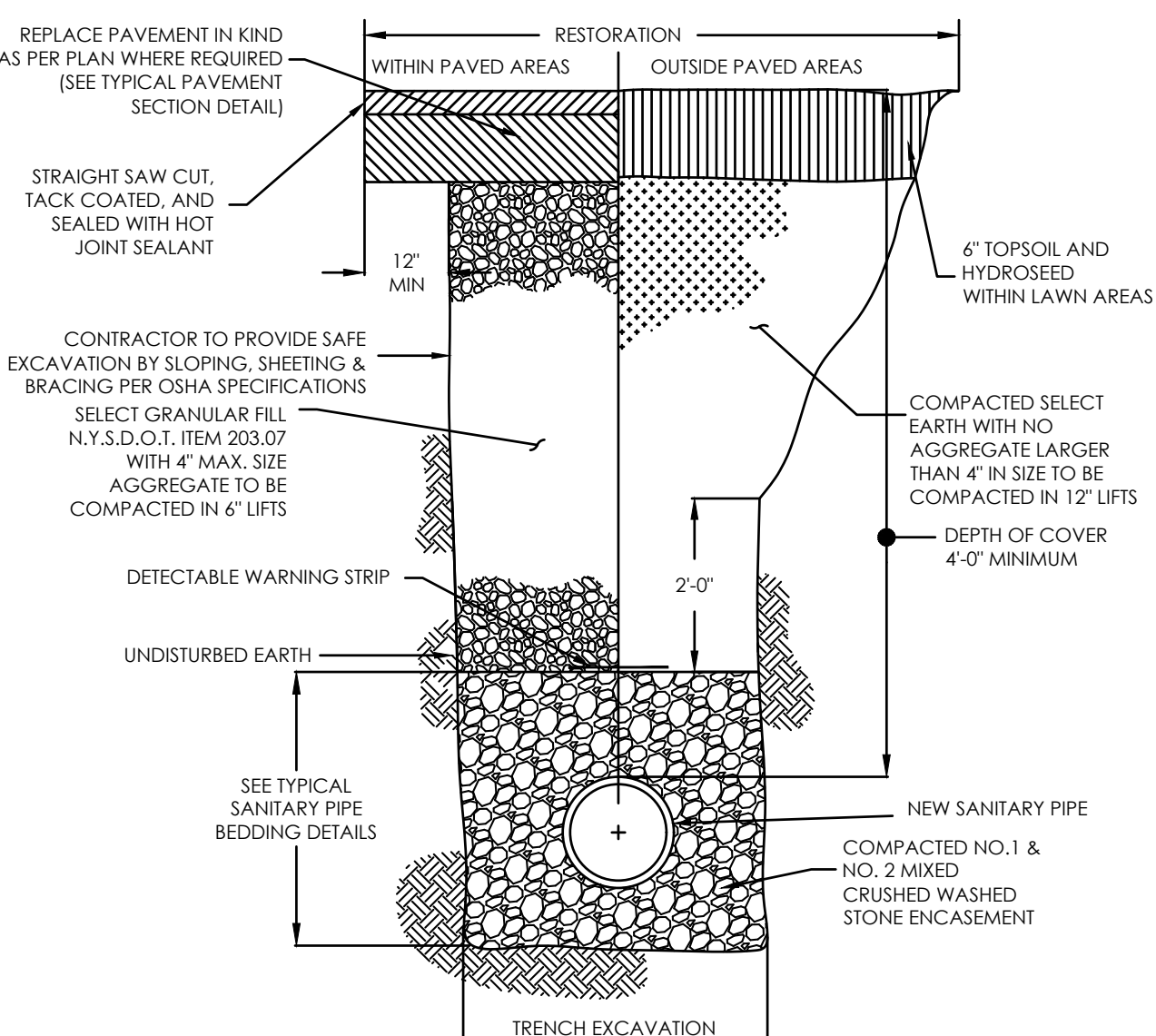

TYPICAL SANITARY TRENCH DETAIL
NOT TO SCALE

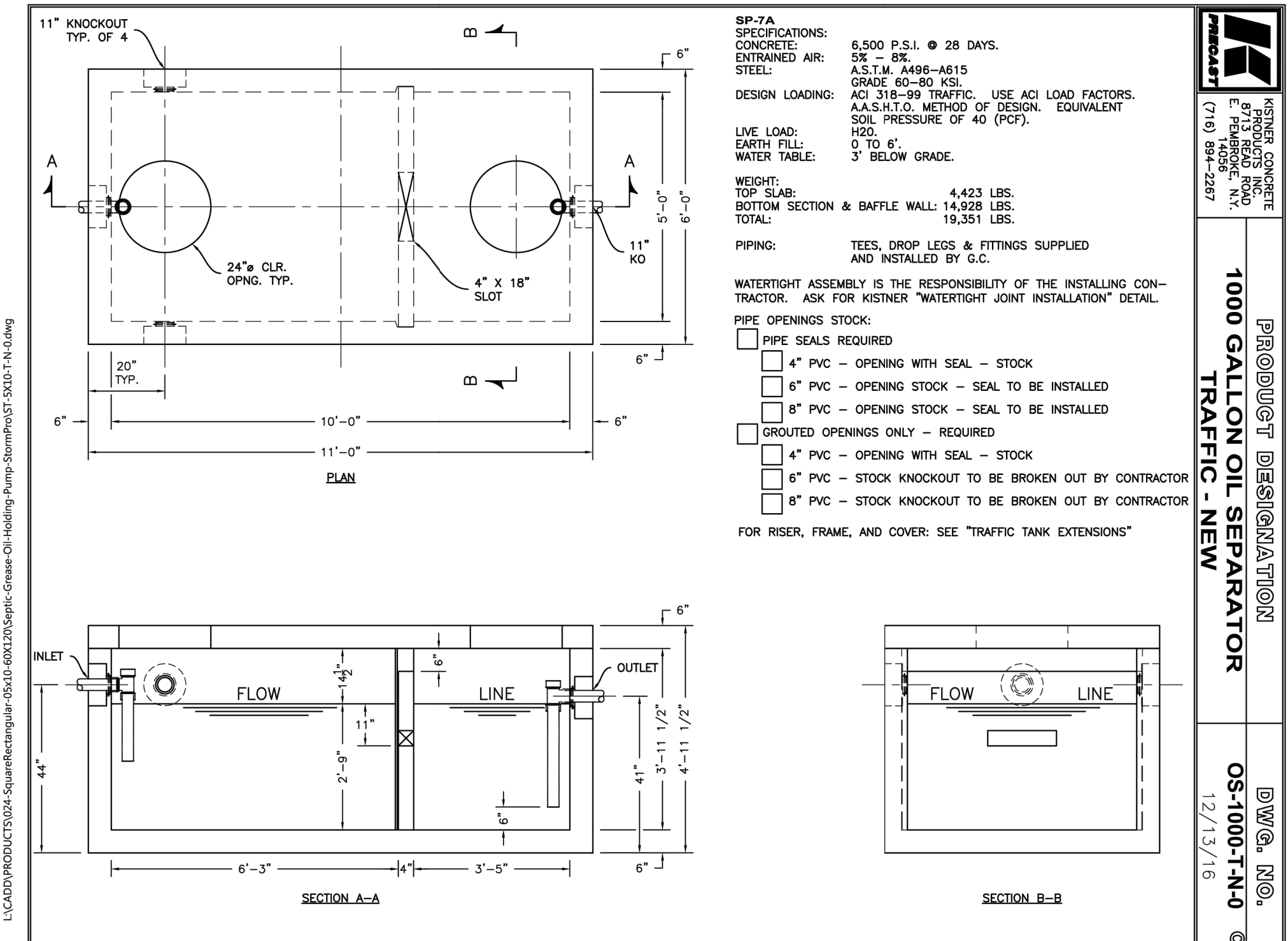

DATE	DESCRIPTION	REV	DESCRIPTION
8-29-22	REVISED PER VILLAGE PB & TOWN ENGINEER COMMENTS	01	
9-29-22	REVISED PER VILLAGE PB & TOWN ENGINEER COMMENTS	02	
11-21-22	REVISED PER VILLAGE PB & TOWN ENGINEER COMMENTS	03	
12-21-22	REVISED PER VILLAGE PB & TOWN ENGINEER COMMENTS	04	
1-21-23	REVISED PER VILLAGE PB & TOWN ENGINEER COMMENTS	05	
2-21-23	REVISED PER VILLAGE PB & TOWN ENGINEER COMMENTS	06	
3-21-23	REVISED PER VILLAGE PB & TOWN ENGINEER COMMENTS	07	
4-21-23	REVISED PER VILLAGE PB & TOWN ENGINEER COMMENTS	08	
5-21-23	REVISED PER VILLAGE PB & TOWN ENGINEER COMMENTS	09	
6-21-23	REVISED PER VILLAGE PB & TOWN ENGINEER COMMENTS	10	



**45 HENDRIX RD
WEST HENRIETTA, NY 14586
PHONE-(585)359-7540
FAX-(585)359-7541**



**SPLASH CAR WASH, INC
472 WHEELERS FARM RD
MILFORD, CT 06461
(585) 303 - 9448**



DATE	DESCRIPTION	REV	DESCRIPTION
8-29-22	REVISED PER VILLAGE PB & TOWN ENGINEER COMMENTS	01	
9-29-22	REVISED PER VILLAGE PB & TOWN ENGINEER COMMENTS	02	
11-21-22	REVISED PER VILLAGE PB & TOWN ENGINEER COMMENTS	03	
12-21-22	REVISED PER VILLAGE PB & TOWN ENGINEER COMMENTS	04	
1-21-23	REVISED PER VILLAGE PB & TOWN ENGINEER COMMENTS	05	
2-21-23	REVISED PER VILLAGE PB & TOWN ENGINEER COMMENTS	06	
3-21-23	REVISED PER VILLAGE PB & TOWN ENGINEER COMMENTS	07	
4-21-23	REVISED PER VILLAGE PB & TOWN ENGINEER COMMENTS	08	
5-21-23	REVISED PER VILLAGE PB & TOWN ENGINEER COMMENTS	09	
6-21-23	REVISED PER VILLAGE PB & TOWN ENGINEER COMMENTS	10	

**129 W GENESEE STREET
SPLASH CAR WASH**
VILLAGE OF FAYETTEVILLE, ONONDAGA COUNTY, NEW YORK
DRAWING TITLE: **CONSTRUCTION DETAILS - 2**
DRAWN BY: **SCH** APPROVED BY: **ESM** PROJ. NO.: **72220023**
CHECKED BY: **CAK** DATE: **6-24-22** PAGE SIZE: **ANSI D**

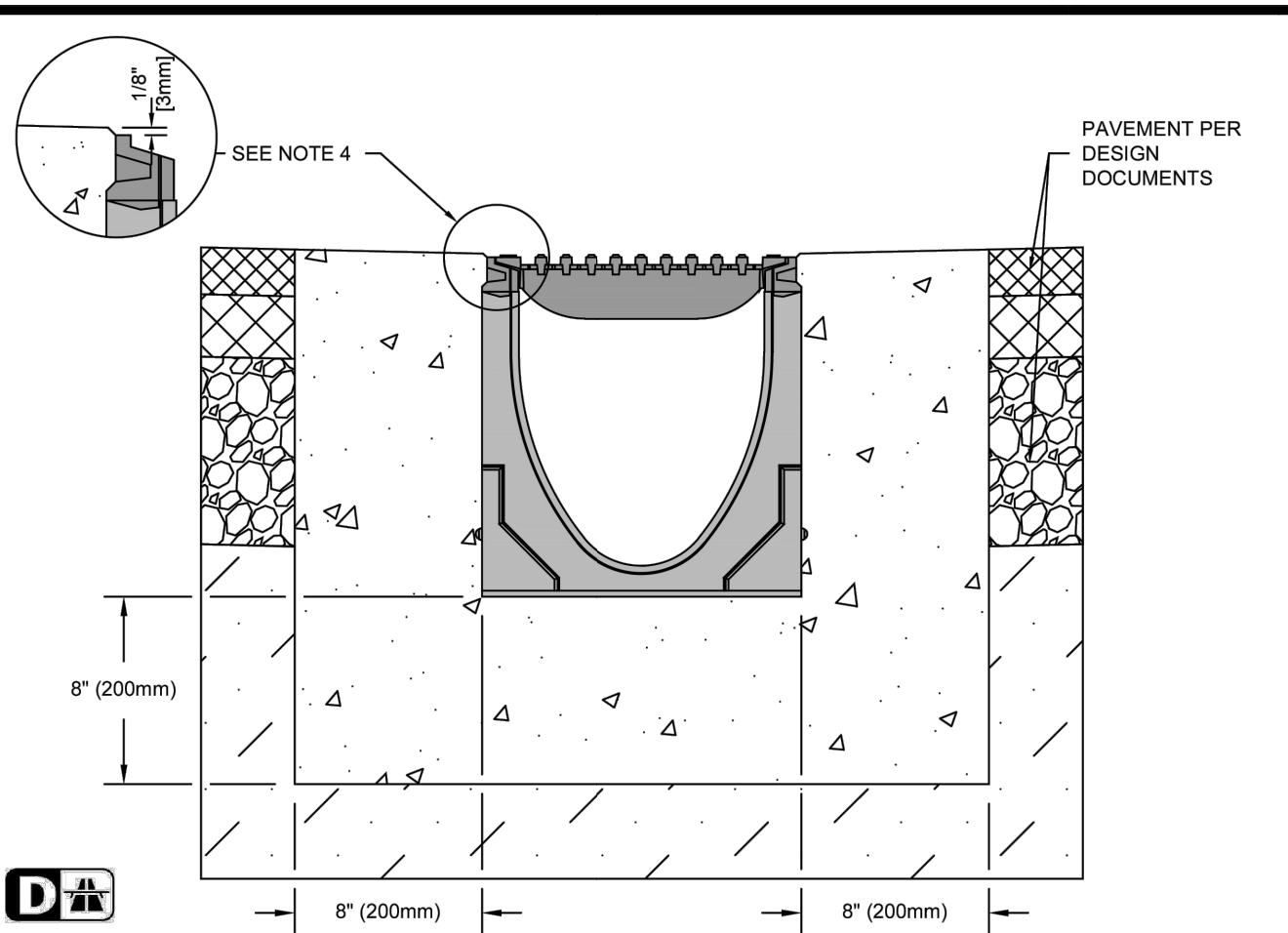

- NOTES:**
1. IT IS NECESSARY TO ENSURE MINIMUM DIMENSIONS SHOWN ARE SUITABLE FOR EXISTING GROUND CONDITIONS. *ENGINEERING ADVICE MAY BE REQUIRED.*
 2. MINIMUM CONCRETE STRENGTH OF 4,000 PSI IS RECOMMENDED. CONCRETE SHOULD BE VIBRATED TO ELIMINATE AIR POCKETS.
 3. EXPANSION AND CONTRACTION CONTROL JOINTS AND REINFORCEMENT ARE RECOMMENDED TO PROTECT CHANNEL AND CONCRETE SURROUND. *ENGINEERING ADVICE MAY BE REQUIRED.*
 4. THE FINISHED LEVEL OF THE CONCRETE SURROUND MUST BE APPROX. 1/8" (3mm) ABOVE THE TOP OF THE CHANNEL EDGE.
 5. CONCRETE BASE THICKNESS SHOULD MATCH SLAB THICKNESS. *ENGINEERING ADVICE MAY BE REQUIRED TO DETERMINE PROPER LOAD CLASS.*
 6. REFER TO ACO'S LATEST INSTALLATION INSTRUCTIONS FOR FURTHER DETAILS.

SK2-D-EAP	S200K - POWERDRAIN - LOAD CLASS: D Exposed Asphalt Pavement	ACO Polymer Products, Inc.		
		825 W. Beechcraft St. Casa Grande, AZ 85122 Tel: 520-421-9888 Fax: 520-421-9889	8470 Pinecone Dr. Mentor, OH 44060 Tel: 440-939-7230 Fax: 440-939-7235	4211 Pleasant Rd. Fort Mill, SC 29708 Tel: 440-639-7230 Fax: 803-902-1063
DATE: 08/25/15	INSTALLATION DRAWING - ACO DRAIN			
Arizona Tel: 888-490-9552 e-mail: sales@acousa.com Ohio Tel: 800-543-4764 www.acousa.com		South Carolina Tel: 800-543-4764		

SPECIFICATION CLAUSE

S200K POWERDRAIN - LOAD CLASS D

GENERAL
THE SURFACE DRAINAGE SYSTEM SHALL BE POLYMER CONCRETE S200K CHANNEL SYSTEM WITH DUCTILE IRON EDGE RAILS AS MANUFACTURED BY ACO POLYMER PRODUCTS, INC.

MATERIALS
CHANNELS SHALL BE MANUFACTURED FROM POLYESTER RESIN POLYMER CONCRETE WITH AN INTEGRALLY CAST-IN DUCTILE IRON EDGE RAIL. MINIMUM PROPERTIES OF POLYMER CONCRETE WILL BE AS FOLLOWS:
COMPRESSIVE STRENGTH: 14,000 PSI
FLEXURAL STRENGTH: 4,000 PSI
TENSILE STRENGTH: 1,500 PSI
WATER ABSORPTION: 0.07%
FROST PROOF: YES
DILUTE ACID AND ALKALI RESISTANT: YES
B117 SALT SPRAY TEST COMPLIANT: YES

THE SYSTEM SHALL BE 8" (200mm) NOMINAL INTERNAL WIDTH WITH A 10.2" (260mm) OVERALL WIDTH AND A BUILT-IN SLOPE OF 0.5%. CHANNEL INVERT SHALL HAVE DEVELOPED "V" SHAPE. ALL CHANNELS SHALL BE INTERLOCKING WITH A MALE/FEMALE JOINT.

THE COMPLETE DRAINAGE SYSTEM SHALL BE BY ACO POLYMER PRODUCTS, INC. ANY DEVIATION OR PARTIAL SYSTEM DESIGN AND/OR IMPROPER INSTALLATION WILL VOID ANY AND ALL WARRANTIES PROVIDED BY ACO POLYMER PRODUCTS, INC.

CHANNEL SHALL WITHSTAND LOADING TO PROPER LOAD CLASS AS OUTLINED BY EN 1433. GRATE TYPE SHALL BE APPROPRIATE TO MEET THE SYSTEM LOAD CLASS SPECIFIED AND INTENDED APPLICATION. GRATES SHALL BE SECURED USING "POWERLOK" BOLTLESS LOCKING SYSTEM. CHANNEL AND GRATE SHALL BE CERTIFIED TO MEET THE SPECIFIED EN 1433 LOAD CLASS. THE SYSTEM SHALL BE INSTALLED IN ACCORDANCE WITH THE MANUFACTURER'S INSTRUCTIONS AND RECOMMENDATIONS.

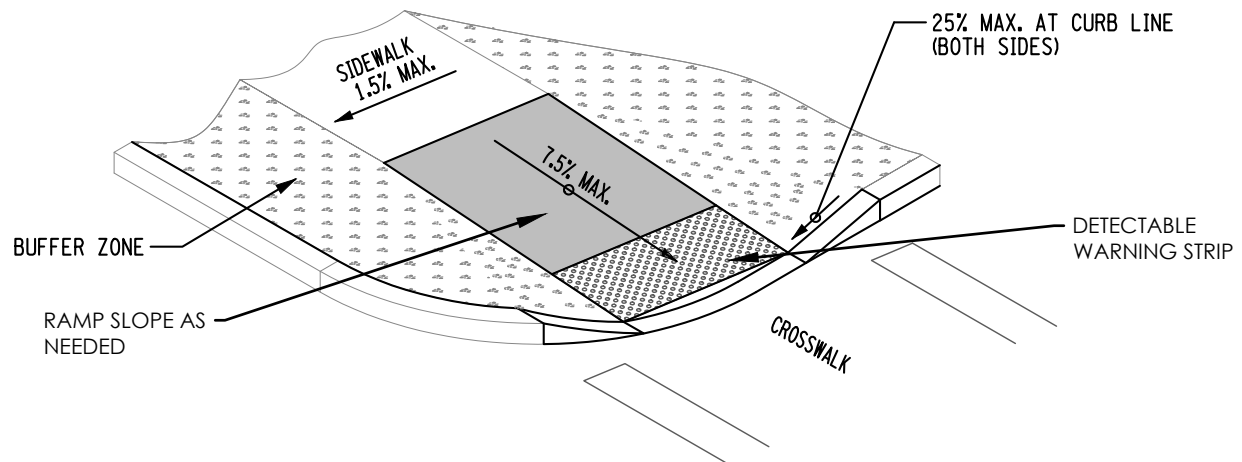

SIDEWALK RAMP: FLARED CONCRETE

NYSDOT PAY ITEM NUMBERS: (FOR NYSDOT WORK)

1. 203.07 - SELECT GRANULAR FILL
2. 304.15 - SUBBASE COURSE, OPTIONAL TYPE
3. 404.098301 - TOP COURSE ASPHALT
4. 404.258901 - BASE COURSE ASPHALT
5. 608.0101 - CONCRETE SIDEWALKS AND DRIVEWAYS
6. 609.0201 - STONE CURB, GRANITE TYPE A
7. 627.50140008 - CUTTING PAVEMENT

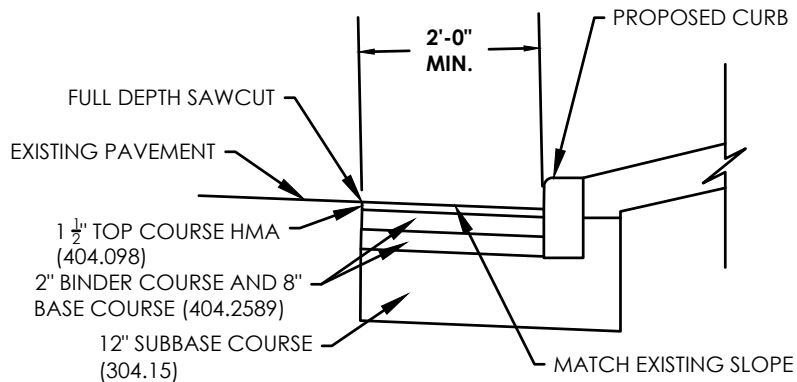

**NYSDOT FULL DEPTH PAVEMENT
RECONSTRUCTION DETAIL**

NOT TO SCALE

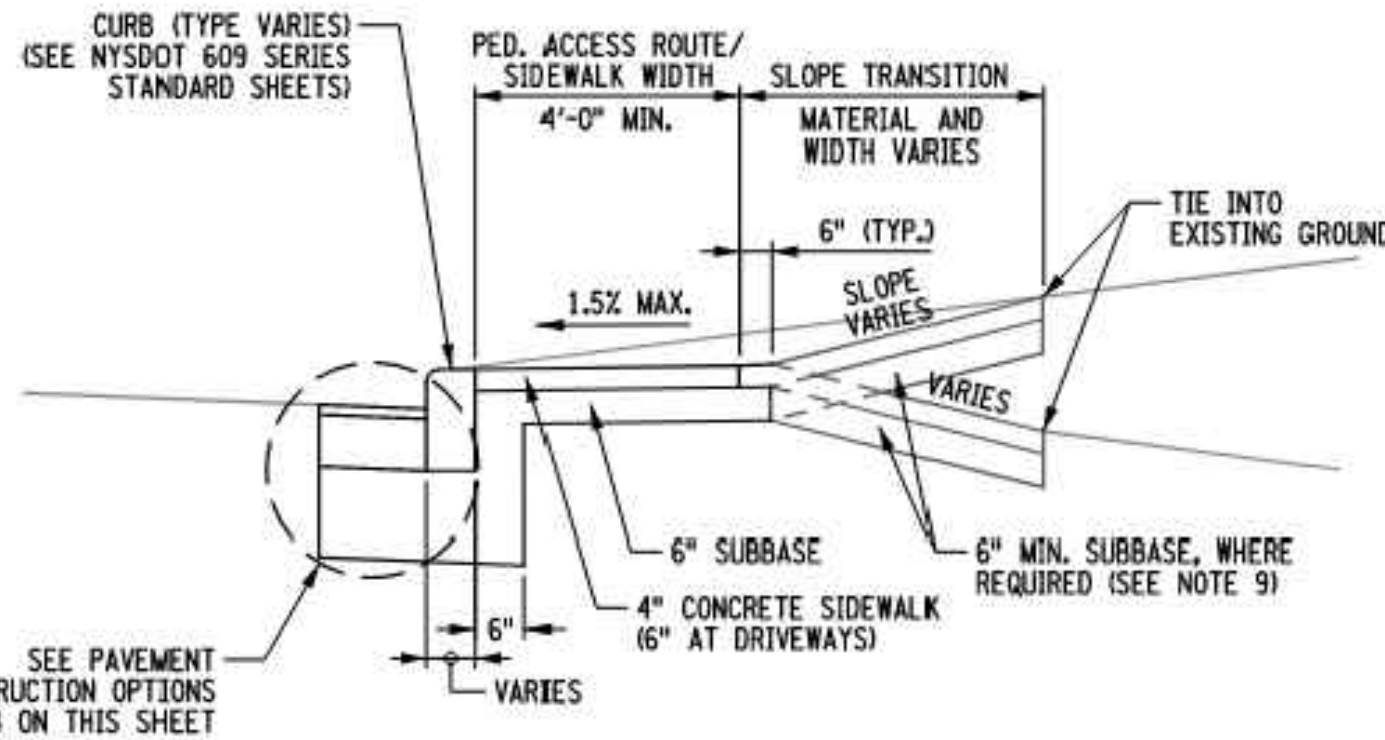

**NYSDOT SIDEWALK
RECONSTRUCTION DETAIL**

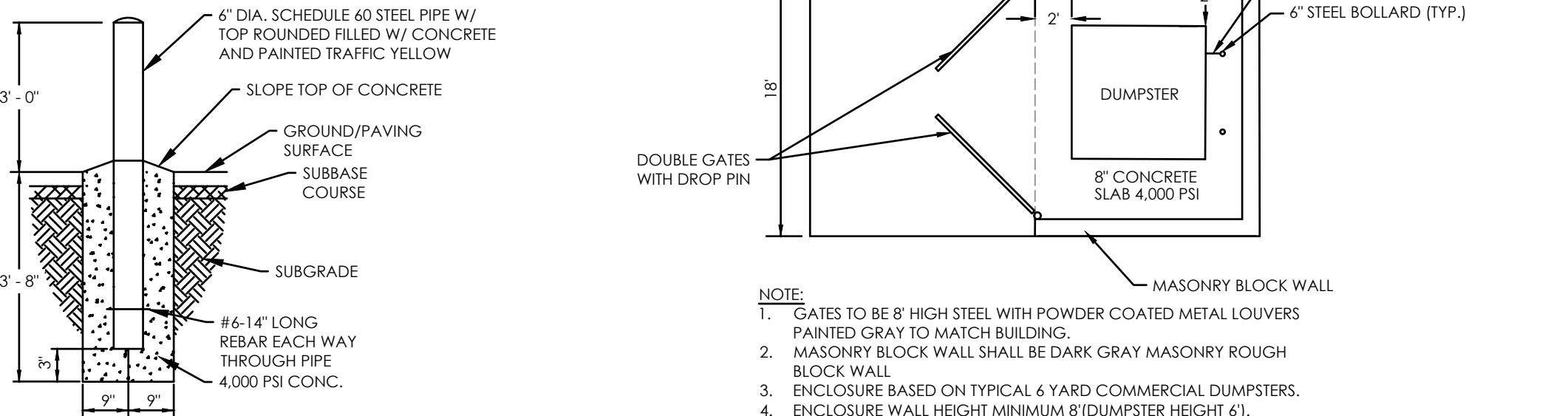

BOLLARD INSTALLATION DETAIL

NOT TO SCALE

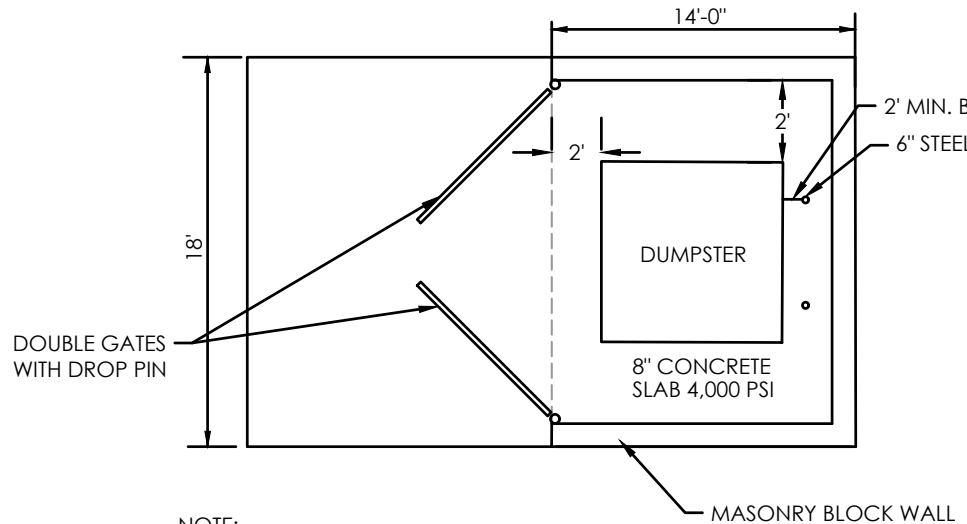

- NOTE:**
1. GATES TO BE 8' HIGH STEEL WITH POWDER COATED METAL LOUVERS PAINTED GRAY TO MATCH BUILDING.
 2. MASONRY BLOCK WALL SHALL BE DARK GRAY MASONRY ROUGH BLOCK WALL.
 3. ENCLOSURE BASED ON TYPICAL 6 YARD COMMERCIAL DUMPSTERS.
 4. ENCLOSURE WALL HEIGHT MINIMUM 8'(DUMPSTER HEIGHT 6').

DUMPSTER ENCLOSURE

NOT TO SCALE

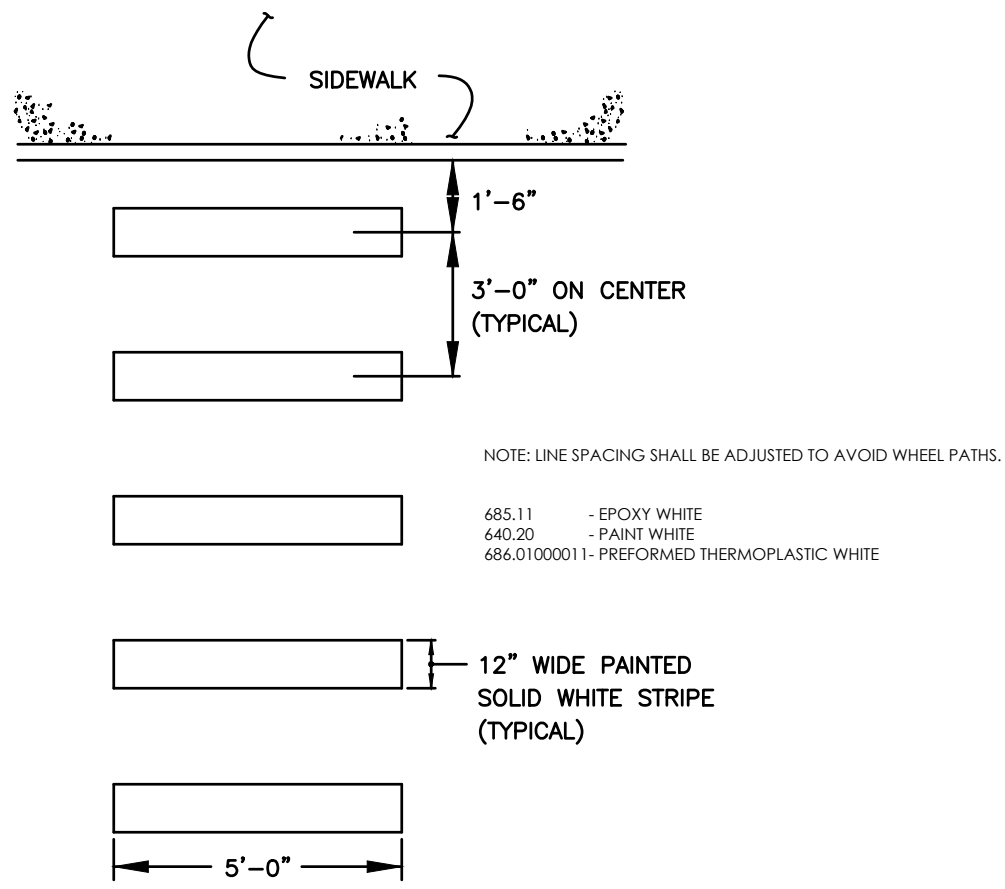

CROSSWALK DETAIL

NOT TO SCALE

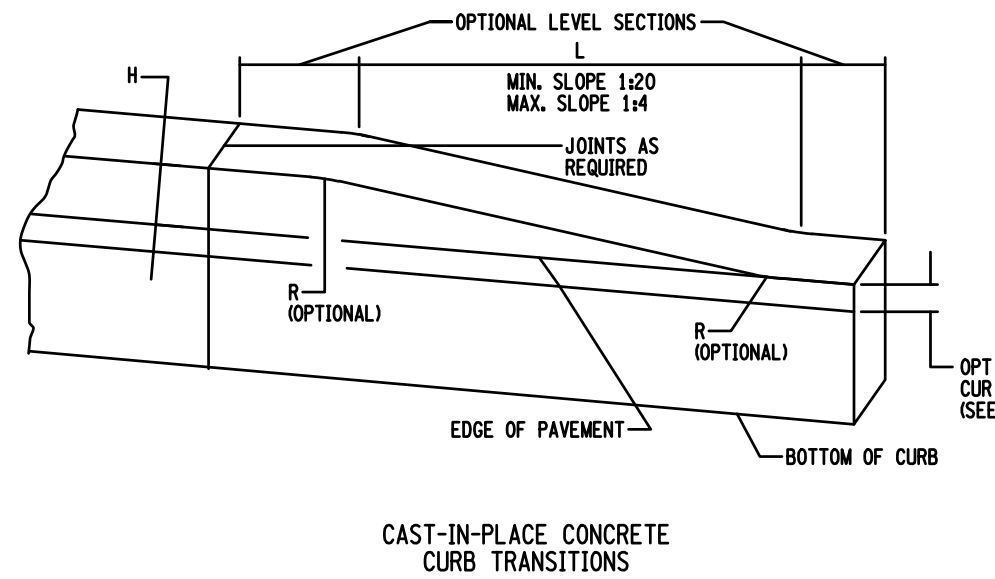

CURB TRANSITION LENGTHS (L)			
H SLOPE	1:4	1:12	1:20
4"	16"	48"	80"
6"	24"	72"	120"

TRANSITION CURB DETAIL

NOT TO SCALE

VERIFY BOLT TEMPLATE BASEPLATE WITH MANUFACTURERS' DRAWINGS

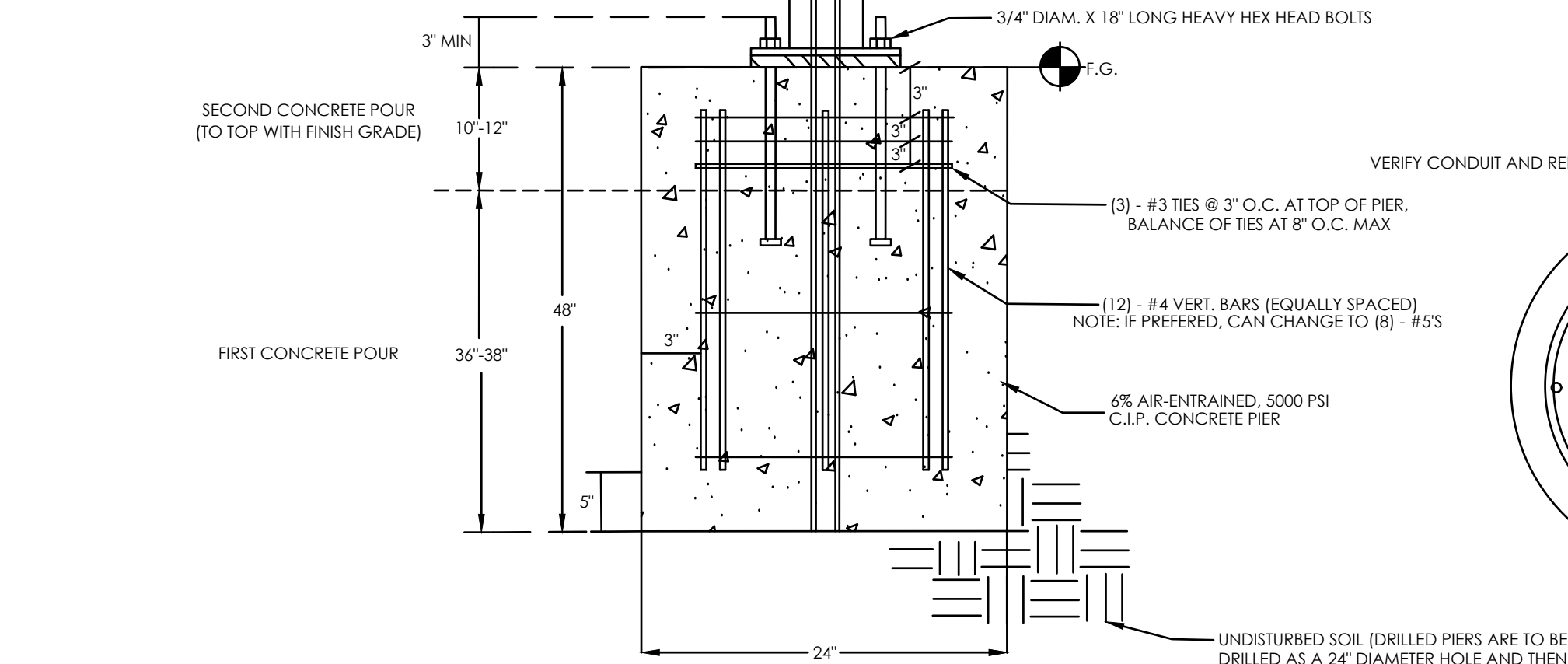
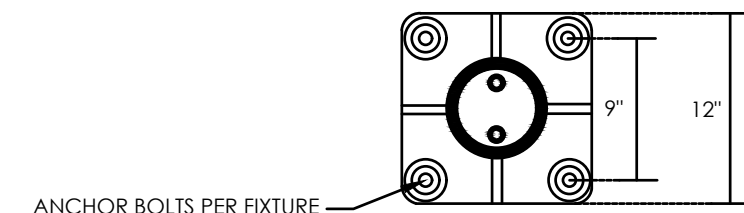

ARCH CANOPY AND VACUUM STANCHION BASE DETAIL

NOT TO SCALE



**45 HENDRIX RD
WEST HENRIETTA, NY 14586
PHONE-(585)359-7540
FAX-(585)359-7541**



**SPLASH CAR WASH, INC
472 WHEELERS FARM RD
MILFORD, CT 06461
(585) 303 - 9448**



REV	DATE	DESCRIPTION
01	8-29-22	REVISED PER VILLAGE PB & TOWN ENGINEER COMMENTS
02	9-29-22	REVISED PER VILLAGE PB & TOWN ENGINEER COMMENTS
03	10-27-22	REVISED PER VILLAGE PB & TOWN ENGINEER COMMENTS
04	11-21-22	REVISED PER VILLAGE PB & TOWN ENGINEER COMMENTS
05	12-21-22	REVISED PER VILLAGE PB & TOWN ENGINEER COMMENTS
06	1-13-23	REVISED PER VILLAGE PB & TOWN ENGINEER COMMENTS
07	2-1-23	REVISED PER VILLAGE PB & TOWN ENGINEER COMMENTS
08	2-13-23	REVISED PER VILLAGE PB & TOWN ENGINEER COMMENTS
09	2-13-23	REVISED PER VILLAGE PB & TOWN ENGINEER COMMENTS
10	10-19-23	EXPANDED DRIVE LANE LAYOUT (REVISED PER TOWN COMMENTS)

129 W GENESEE STREET SPLASH CAR WASH		CONSTRUCTION DETAILS - 3	
VILLAGE OF FAYETTEVILLE, ONONDAGA COUNTY, NEW YORK		DRAWING TITLE:	
DRAWN BY: SHC		ESM PROJ. NO: 72220023	
CHECKED BY: CAK		DATE: 6-24-22	
REV: 10		DRAWING NO: C11	

